



DA2108



DA2110



DA2112

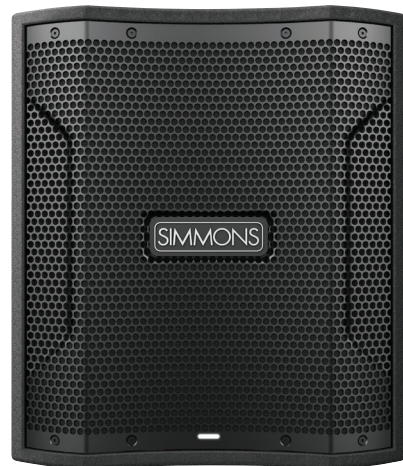

DA12S

SIMMONS

DA2100 SERIES

ADVANCED ELECTRONIC DRUM AMPLIFIERS

OWNER'S MANUAL

WELCOME

For electronic drummers and pad players who want the best sound for their drums and tracks, the Simmons DA2100 Series combines high-fidelity sound with Bluetooth and stereo line inputs, in a selection of different power and speaker configurations to serve both beginners and pros. The available DA12S Subwoofer adds high impact low frequencies for use with any single amp, or Smart Stereo setup.

HIGH-FIDELITY SOUND FOR DRUMS AND TRACKS

Every unit features a modern 2-way speaker design, acoustically designed cabinet, high-frequency compression driver, and high peak output power, to accurately render the wide dynamic range and transient punch of percussion instruments.

SMART STEREO

Using a pair of DA2100 Series amplifiers, you can fully immerse yourself in surrounding stereo, hearing each element of your drum kit at its proper place in the stereo field. The first amplifier will control the volume and tone for the full rig, making it easy to step up to this level of sonic inspiration.

FLOOR/POLE

Place your DA2100 Series amplifier on the floor like a traditional amp, or take advantage of the pole mount to bring the sound to ear level. A floor/pole switch ensures consistent frequency response in either placement.

DA2112

Designed for electronic drummers who need a high-powered and versatile amplifier, the Simmons DA2112 combines high-fidelity sound and stage-ready power with 3 stereo line inputs, Bluetooth audio input, and flexible monitoring of metronome, click and guide tracks. Experience high-impact bass and studio monitor-style sound quality for your drums and tracks, and take full control of your tone with 4 knob EQ. The versatile cabinet can be placed on the floor or on a speaker pole, and Smart Stereo capability lets you use link two DA2112s to immerse yourself in full stereo sound, with unified control from the master unit. Headphone output with separate volume completes the package.

KEY FEATURES

- Premium 12" speaker + 1.35" compression driver
- 350 Watts RMS, 2000W Peak, 126dB Max SPL
- 3 Stereo Line Inputs, Aux Input & Bluetooth
- 4 Knob EQ to take full control of your sound
- Headphone out with separate volume knob
- Versatile monitoring options for metronome, click and guide tracks
- Place DA2112 on the floor like a traditional amp, or on a speaker pole for ear-level sound
- Detachable mobile device holder included

DA2110

Designed for electronic drummers who need a powerful practice amplifier, the Simmons DA2110 combines high-fidelity sound and ample power with 2 stereo line inputs, Bluetooth audio input, and aux input. Experience rich bass response and studio monitor-style sound quality for your drums and tracks, while taking control of your tone with 3 knob EQ. The versatile cabinet can be placed on the floor or on a speaker pole, and Smart Stereo capability lets you link two DA2110s to immerse yourself in full stereo sound, with unified control from the master unit. Headphone output for silent practice completes the package.

KEY FEATURES

- Premium 10" speaker + 1" compression driver
- 100 Watts RMS, 400W Peak, 120dB Max SPL
- 2 Stereo Line Inputs, Aux Input & Bluetooth
- 3 Knob EQ to take control of your sound
- Headphone out for silent practice
- Place DA2110 on the floor like a traditional amp, or on a speaker pole for ear-level sound
- Detachable mobile device holder included

DA2108

Designed for electronic drummers who need a high quality practice amplifier, the Simmons DA2108 combines high-fidelity sound with stereo line input, Bluetooth audio input, and aux input. Experience studio monitor-style sound quality for your drums and tracks, while tailoring your tone with 2 knob EQ. The versatile cabinet can be placed on the floor or on a speaker pole, and Smart Stereo capability lets you link two DA2108s to immerse yourself in full stereo sound, with unified control from the master unit. Headphone output for silent practice completes the package.

KEY FEATURES

- Premium 8" speaker + 1" compression driver
- 100 Watts RMS, 400W Peak, 118dB Max SPL
- Stereo Line Input, Aux Input & Bluetooth
- 2 Knob EQ to adjust your sound
- Headphone out for silent practice
- Place DA2108 on the floor like a traditional amp, or on a speaker pole for ear-level sound
- Detachable mobile device holder included

DA12S

Add the Simmons DA12S Drum Amplifier Subwoofer to make high impact low frequencies part of your amplification setup for your electronic drums. High headroom, low distortion, and a transparent, dynamic DSP limiter provide outstanding clarity and impact even when pushed to the max. Set the crossover either by the speaker size of the amps you're pairing up with, or by frequency. The time-align delay then ensures maximum low frequency response by avoiding phase alignment issues for any physical setup. And with 130dB Max SPL output, you can be confident this sub will deliver the clean, deep bass you need to let you feel your kick, toms, and every other element of your electronic drum kit.

KEY FEATURES

- Premium 12" high-temperature sub driver
- 400 Watts RMS, 1000W Peak, 130db Max SPL
- Dual Combo-Jack Line Inputs and XLR Output
- Time Aligning Delay guarantees max bass response when used in any rig
- Crossover Frequency adjustable to match a specific full-range speaker size or frequency (Hz)
- Road-worthy plywood cabinet with rugged polyurea coating for durability
- Side handles for easy handling in transport

INITIAL SETUP

Position your DA2100 Series amplifier in the desired location, and ensure the amp is stable.

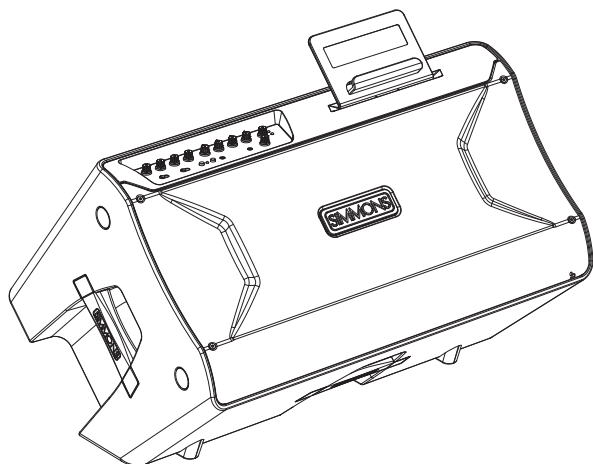

Floor

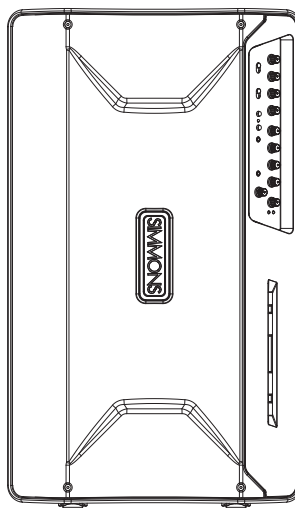

Free-standing

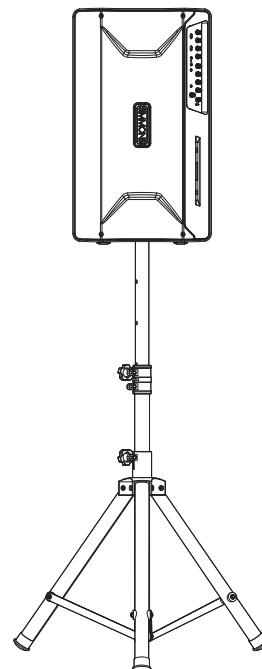

Pole
(speaker stand not included)

POWER

- Make sure the ① power switch is set to the off position.
- Connect the included detachable IEC power cable from a power outlet to the ② power cable input.
- The ③ red voltage switch comes factory-set to the position appropriate for the market where the amplifier is sold. For the USA, this is 110-120V.

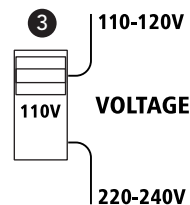
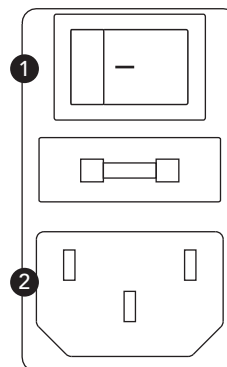

DEVICE HOLDER

- Each model in the DA2100 series ships with a removable mobile device holder as an accessory inside the retail packaging.
- When using your amp in floor wedge position, you can attach the holder to the front-panel as shown below.
- Slide the angled bottom end of the device holder into the ❶ front panel slot, until it ❷ clicks into place.
- Now you can keep your ❸ tablet or smart-phone held in a convenient position during performance or rehearsal.
- Please remove the cradle before transporting the amplifier, or when using the amplifier on a speaker pole or standing upright.

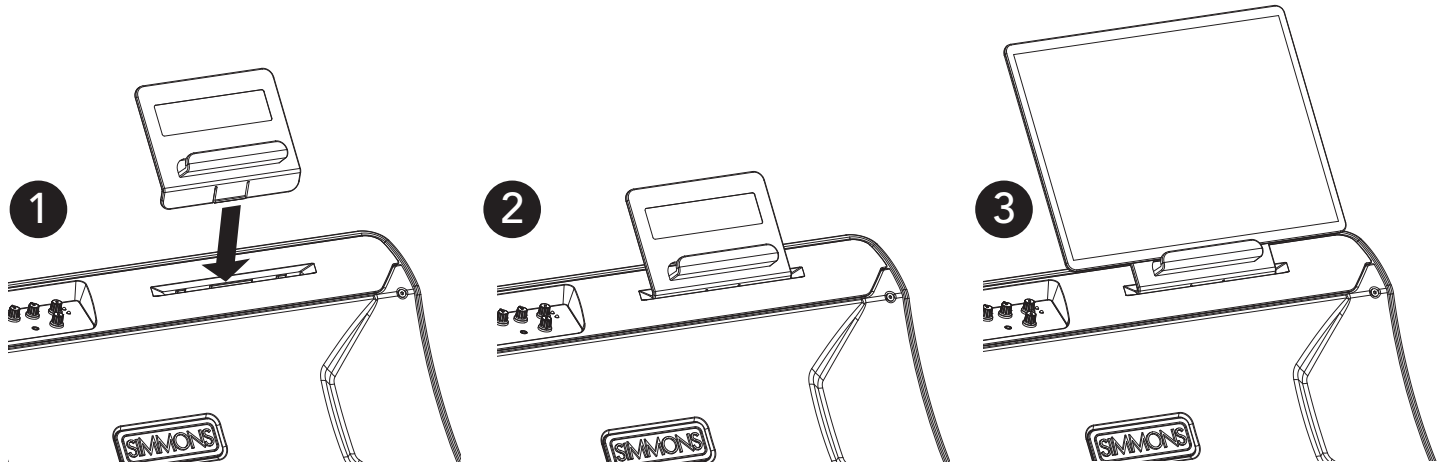

BLUETOOTH® CONNECTING

- Press the ❶ front panel On/Pair button so that the ❷ Bluetooth LED flashes, indicating that Bluetooth audio is enabled and ready for pairing
- From your Bluetooth source device, select your drum amplifier's model number (DA2108, DA2110 or DA2112) to pair
- Play audio from your source device, making sure your device's volume is turned up, as well as the amplifier's volume

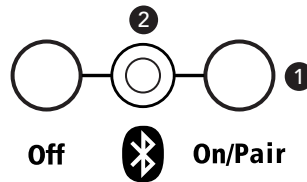

BLUETOOTH® TROUBLESHOOTING

These steps should resolve any Bluetooth trouble you may encounter:

Power off the DA2100 Series amplifier and leave it off, then follow directions for Apple and Android devices below:

- On your Apple iOS device
 1. Open Settings app, select Bluetooth
 2. If your amplifier is listed under MY DEVICES, touch info button, tap to Forget This Device
 3. Turn off Bluetooth, wait 10 seconds, turn on Bluetooth
- On your Android device
 1. Open Settings, select Bluetooth
 2. If your amplifier is listed under Paired Devices, touch gear icon, and tap to unpair
 3. Turn off Bluetooth, wait 10 seconds, turn on Bluetooth

Then power on your DA2100 Series amplifier, press the Bluetooth On/Pair button, and follow the Bluetooth Connecting steps above

QUICK START: INPUT

INPUTS

- Connect your electronic drum sound module's audio outputs to the **1** INPUT 1 jacks on the amplifier rear panel
- Stereo Input: use 2 cables to connect to both the INPUT 1 LEFT(MONO) and RIGHT jacks
- Mono Input: use 1 cable to connect to the INPUT 1 LEFT(MONO) input jack only
- If you'd like to amplify additional sources, connect them to the remaining rear panel inputs, or the front panel aux input

ROUTING SWITCH

- If you are using a single DA2100 series amplifier, set the **2** rear panel switch to Mono
- For dual-amp stereo configuration, see Smart Stereo on the next page

DA2108 REAR PANEL

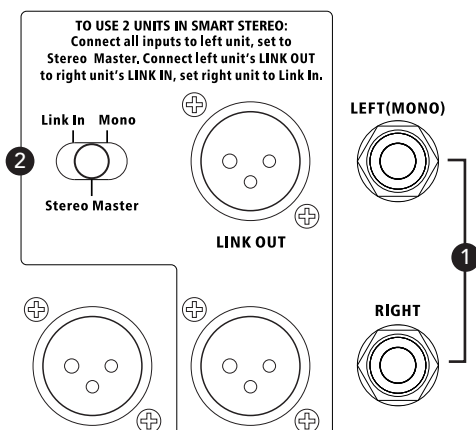

DA2110 REAR PANEL

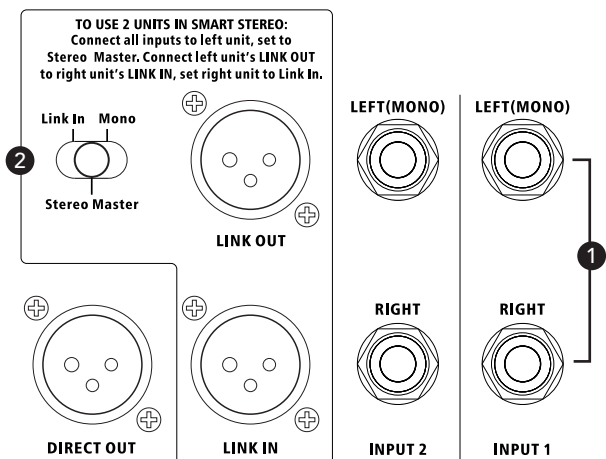

DA2112 REAR PANEL

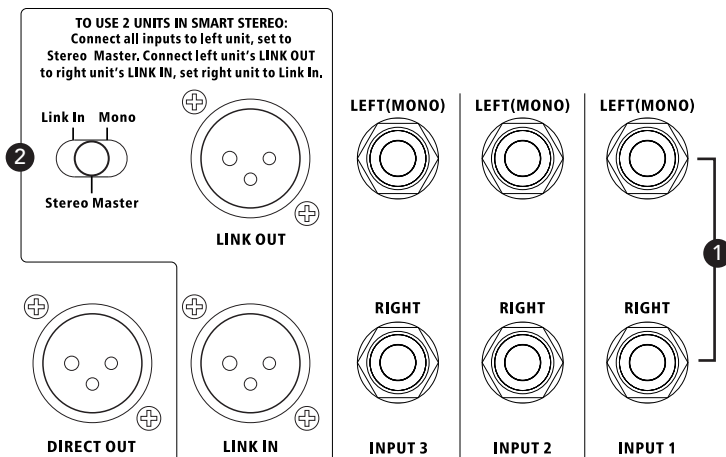

QUICK START: CONTROLS

VOLUME CONTROLS

- Turn all **3** input level control knobs to the minimum position
- DA2112 only: also turn the Master **4** knob to minimum

VOICING SWITCH

- Set the **5** Voicing switch to Floor when using the amplifier lying horizontally on the floor, or free-standing vertically
- Set the switch to Pole when using the amplifier on a speaker pole

POWER ON

- Power on the drum sound module and set its output volume to max
- Then power on the amplifier, via the rear panel switch
- DA2112 only: turn the Master **4** knob to noon position
- Turn up the INPUT 1 knob **3** while playing your drum sound module, until you reach a comfortable listening level

EQ

- Turn the EQ knobs **6** to adjust your tone as desired

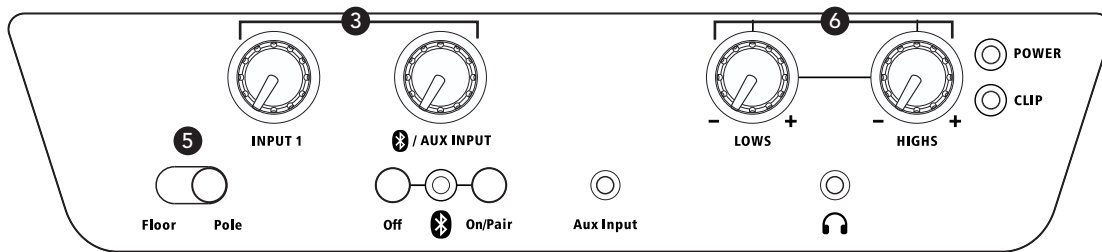

DA2108 FRONT PANEL

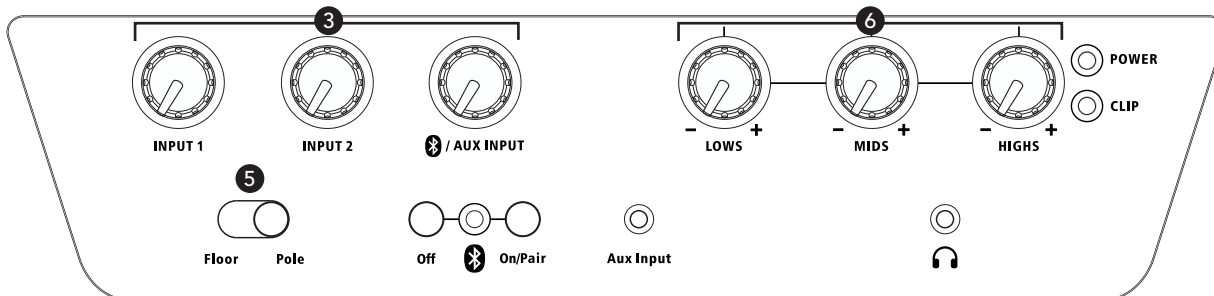

DA2110 FRONT PANEL

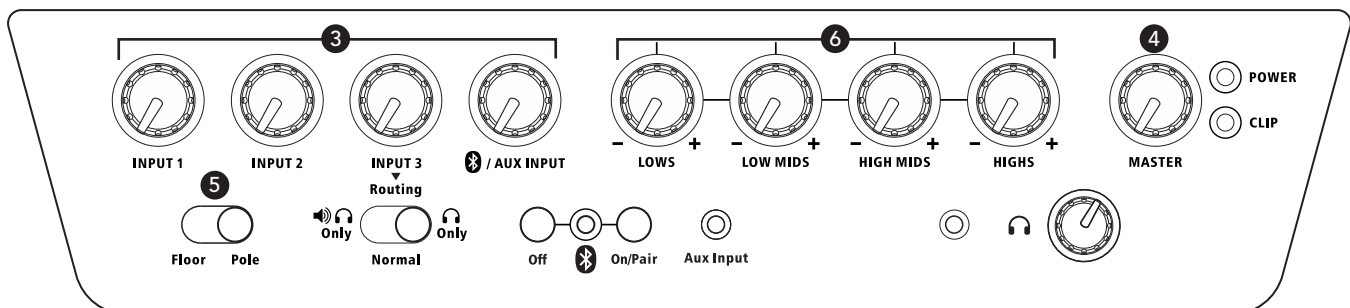

DA2112 FRONT PANEL

SMART STEREO WITH PAIR OF AMPLIFIERS

A pair of DA2100 Series amplifiers can operate together as a Smart Stereo system, giving you control of the sound and volume of both amplifiers from the first master amplifier, and optimally distributing all audio inputs to both for rich stereo sound.

- Use two like amplifiers: two DA2108s, two DA2110s, or two DA2112 amplifiers
- Set the switch on the first amplifier to Stereo Master
- Set the switch on the second amplifier to Link In
- Connect a standard microphone cable (female XLR to male XLR cable) from the first unit's LINK OUT jack to the second unit's LINK IN jack

CONNECT ALL INPUTS TO FIRST AMPLIFIER ONLY

- Connect all inputs and make all sound settings on the first (left) unit only, this will be the master amplifier
- All inputs and controls on the second amplifier will be disabled, except that on DA2112 you must set the second amp's Master Volume to max
- For headphones, use the headphone jack on the first amplifier

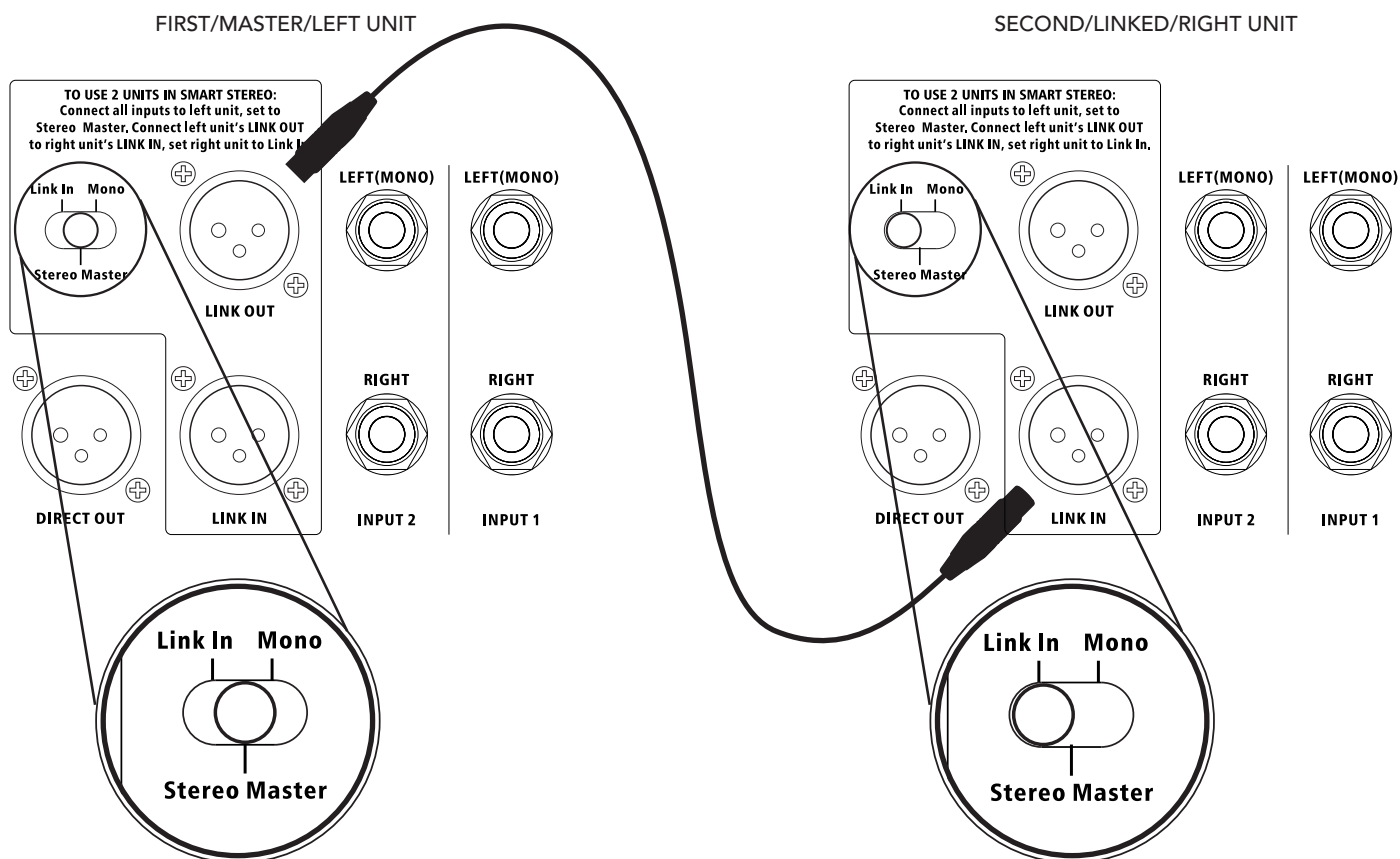

SMART STEREO WITH SUBWOOFER OR DIRECT OUT

To connect a subwoofer, or a direct out, the setup is the same as on the opposite page, but you can add a connection from the first unit's DIRECT OUT jack to a subwoofer or other audio receiving device, as shown below.

- The DIRECT OUT provides a full-range, mono signal
- The DIRECT OUT level is not effected by the MASTER knob of the DA2112.

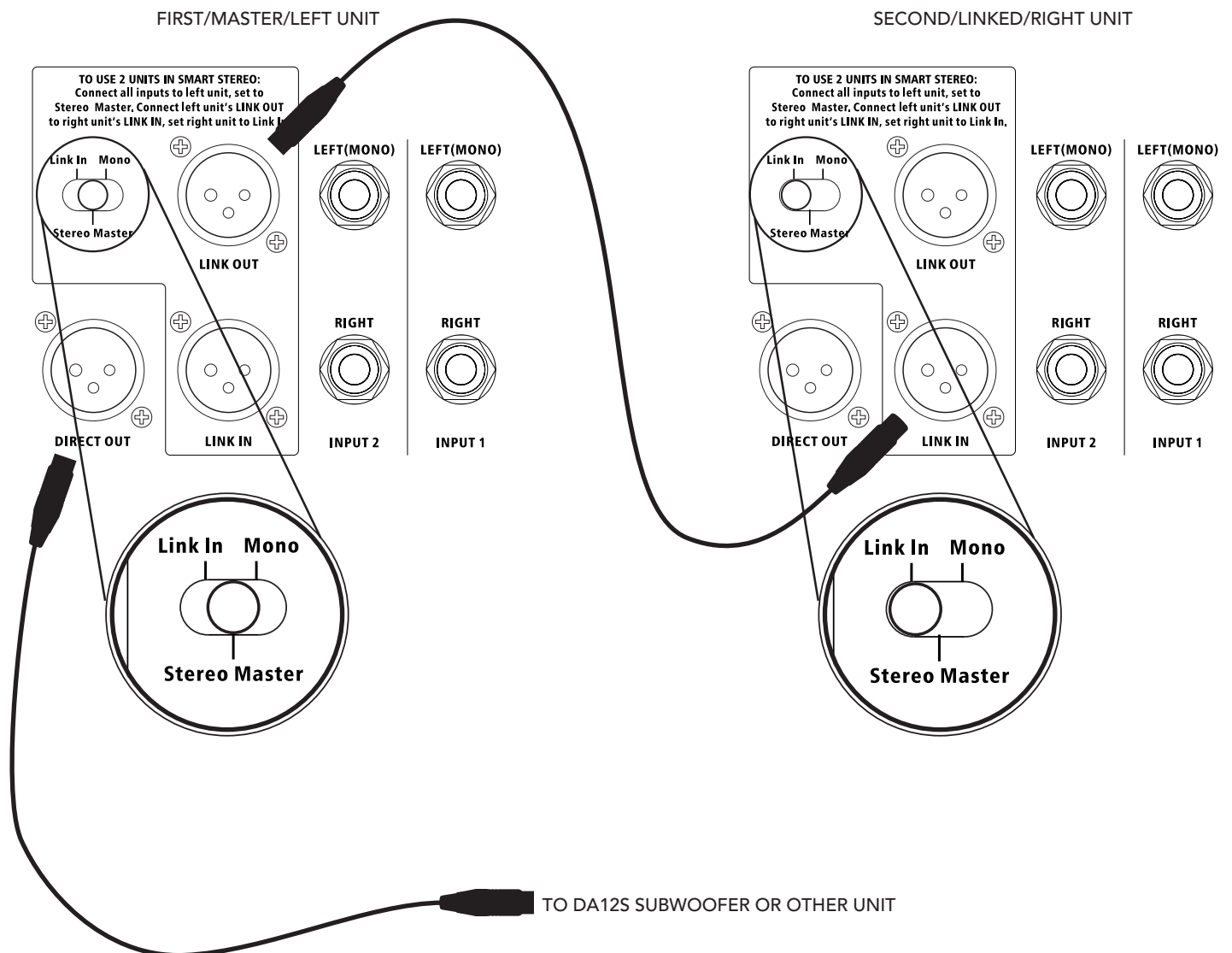

CONNECTIONS AND CONTROLS

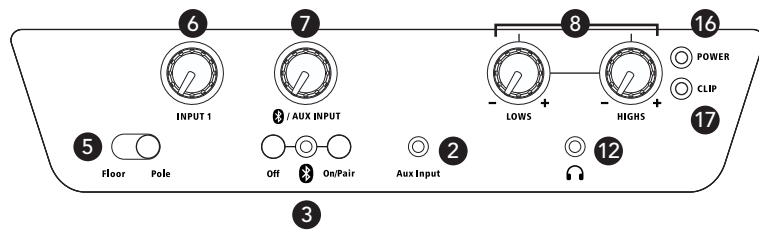

DA2108 FRONT PANEL

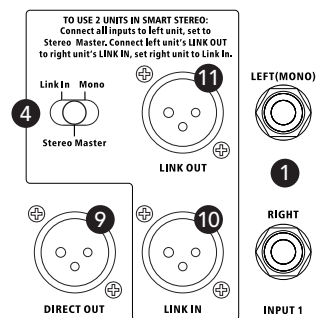

DA2108 REAR PANEL

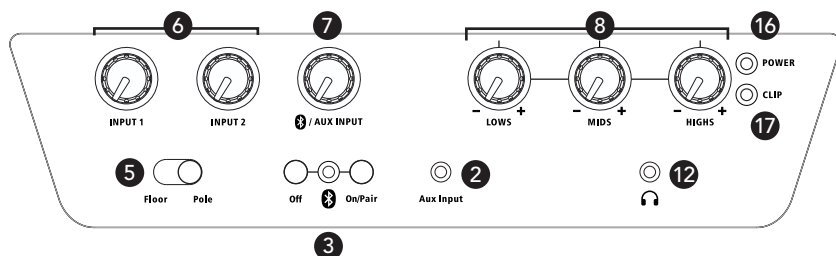

DA2110 FRONT PANEL

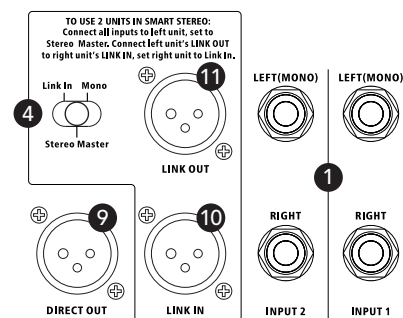

DA2110 REAR PANEL

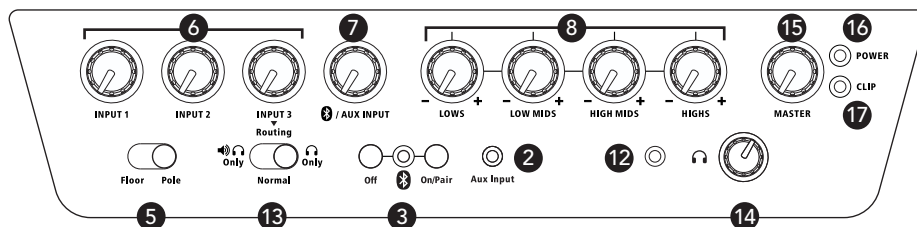

DA2112 FRONT PANEL

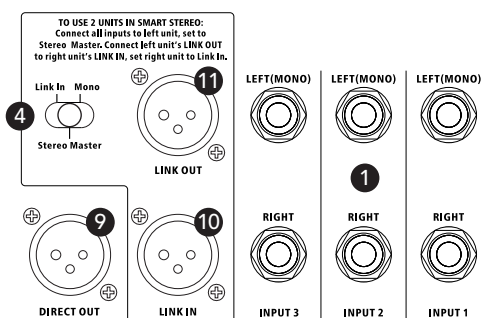

DA2112 REAR PANEL

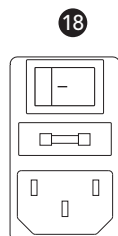

REAR PANEL POWER

CONNECTIONS AND CONTROLS

1 REAR PANEL BALANCED LINE INPUTS

- Balanced or unbalanced line level sources can be connected here.
- Mono sources: connect to Left/Mono jack only
 - Stereo sources: connect separate cables to Left/Mono and Right

2 FRONT PANEL AUX INPUT

- Use this input to connect the audio cable from a computer, smartphone, tablet, or other audio source.
- This jack accepts stereo or mono input.

3 BLUETOOTH AUDIO INPUT

The On/Pair button forces any currently connected Bluetooth audio source to disconnect, and makes the amplifier available for pairing.

The Off button disables Bluetooth.

To pair, look for your amplifier's model number (DA2108, DA2110, or DA2112) from your Bluetooth audio source device

- The LED blinks when available for pairing.
- The amplifier's Bluetooth LED is lit solid when currently paired.
- The LED is off if Bluetooth has been disabled by a press of the Bluetooth Off button.

When Bluetooth is off, and you press the On/Pair button

- The amplifier will automatically reconnect to the previous Bluetooth audio source if it is available
- It will otherwise be available for Bluetooth pairing from a source audio device such as a smartphone

4 MONO / STEREO MASTER / LINK IN SWITCH

- Mono: This amplifier will output mono audio, and send mono audio to the OUT jack so it's available for any other amplifier or sound system.
- Stereo Master: This amplifier will operate as the master unit of a Smart Stereo pair. Use a mic cable (female XLR to male XLR cable) to connect this amplifier's LINK OUT to the LINK IN jack of a second amplifier of the same type. All inputs should be connected to the first master amplifier, which will also set the volume and tone of both amplifiers.
- Link In: Use this setting for the second amplifier of a Smart Stereo pair. The audio from the LINK IN will be routed directly to the power amp and speaker, with all other inputs and controls being ignored, except that on DA2112, the master volume knob on the Link In unit must be set to max.

5 FLOOR/POLE VOICING SWITCH

The switch tunes the amplifier to give a consistent frequency response whether placed on the floor or on a speaker pole:

- FLOOR: standard tuning, to be used when the amplifier is lying horizontally on the floor, or free-standing vertically on the floor
- POLE: optimizes the tuning for use on a speaker pole

6 LEVEL KNOBS FOR REAR PANEL INPUTS

These knobs set the input volumes for the rear panel inputs.

7 LEVEL KNOB FOR BLUETOOTH/AUX INPUT

This knob sets the input volumes for both Bluetooth audio input, and the front panel aux input jack.

8 EQ KNOBS

Adjust the overall sound of the amplifier for your sonic preference.

9 DIRECT OUT JACK

- Sends out a mono mix of all input signals of the DA2108 or DA2110.
- See 13 for DA2112's direct out routing options.

10 LINK IN JACK

Activated only when 4 switch is set to LINK IN

- Audio received at this jack is routed directly to the power amp, bypassing the volume and EQ knobs of the receiving amplifier
- See previous page Smart Stereo configurations

11 LINK OUT JACK

Configured by 4 switch

- Mono: sends out mono audio.
- Stereo Master: sends out right audio, for second amplifier's LINK IN.
- Link In: sends out the same audio received at the LINK IN jack.

12 STEREO HEADPHONE OUTPUT

Connect headphones here to hear a stereo mix of all input signals of the DA2108 or DA2110.

- The headphone output level is determined by the input level controls
- DA2112 headphone output level is set by a dedicated 14 knob.
- See 13 for DA2112's headphone routing options.

13 DA2112 ONLY: INPUT 3 ROUTING SWITCH

This feature can be helpful when you want to monitor a click track, guide track or metronome, without it being amplified through the speaker or sent to the direct out. Connect that source to INPUT 3, and set this switch as desired:

- Center (normal): Input 3 goes to all outputs, like all other inputs.
- Left (Speaker+Phones): Input 3 goes to speakers and headphones only, it is NOT included in the direct out.
- Right (Phones Only): Input 3 goes the headphones only, it is not sent to speakers or direct out.

14 DA2112 ONLY: HEADPHONE LEVEL KNOB

Sets the level for headphones, independent of the DA2112 master volume control

15 DA2112 ONLY: MASTER VOLUME KNOB

Adjusts the volume level from the amplifier and speakers, independent of the headphone volume.

16 POWER LED

Lit when unit is powered on.

17 CLIP LED

Lit when power amp is clipping.

DA2108/DA2110: Turn down 6 input level knobs if CLIP LED lights.

DA2112: Turn down 6 input level knobs or MASTER 15 knob if CLIP LED lights.

18 POWER INLET, SWITCH, AND FUSE

Connect included power cable to power inlet.

- If amplifier will not power on and you suspect its fuse may have blown, turn off the power switch, and open the fuse compartment next to the power switch using a small flat blade screwdriver.
- If metal strip in fuse is broken, replace with fuse type indicated on rear panel.

DA12S QUICK START GUIDE

SETTING UP / HELPFUL TIPS

- Position the DA12S in the desired location, and ensure the cabinet is stable.
- Make sure the Power Switch is off.
- Make certain VOLUME knob is turned down.

MAKING THE CONNECTIONS

- See page 9 for the most common setup with Simmons drum amps.
- Or see illustrations of other setup options below.
- See facing page information regarding Level switch

CROSSOVER FREQUENCY

- Turn the knob to select a frequency for the crossover.
- Recommended settings for common sizes of full-range speakers are indicated.

PHASE/LEVEL

- For initial use, Phase should be set to 0.
- For initial use, Level should be set to -10.

POWERING UP

- Turn on the power to any devices plugged into Input 1 or Input 2.
- Power ON the DA12S.
- Slowly turn the VOLUME knob to 12 o'clock.
- Slowly turn up the source volume to the desired level.

SIGNAL/LIMIT/LEVEL

- The SIGNAL LED will light green when input audio is detected.
- If the limiter is triggered, the LIMIT LED will turn RED, indicating the VOLUME knob should be turned down to avoid distorted sound.
- If the LIMIT LED comes on when the VOLUME knob is already at a low level, try setting the LEVEL switch to +4, and see information regarding LEVEL switch on facing page.

PHASE/TIME ALIGNING DELAY

- Set up your system, and play audio through the system to evaluate the low frequency response.
- Try PHASE set to 0, then 180, and leave the switch on the setting that provides more low frequency impact.
- Turn TIME ALIGNING DELAY knob until the maximum sub bass is heard.

LINKING MULTIPLE SUBWOOFERS

- If linking multiple subwoofers, plug the OUTPUT connection(s) of the first subwoofer to the INPUT connection(s) of second subwoofer, and continue the daisy chain to the next speaker.
- Turn the Power On in the order of the audio signal to prevent unwanted "pops". First On / Last Off.

HOOK UP DIAGRAMS

DA12S in-line with audio source

Set DA12S crossover to match the size of speakers you are sending audio to, or as speaker manufacturer recommends

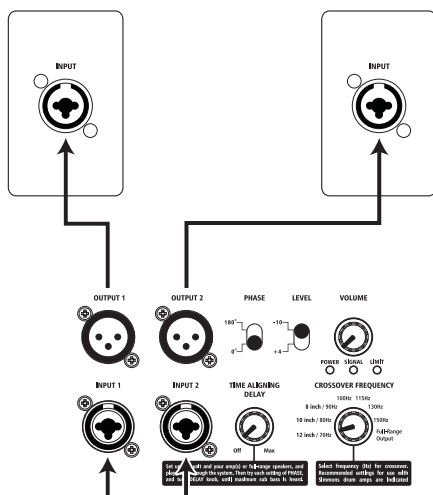

Mixer or other source

Feed-through from main speakers

Mixer or other source

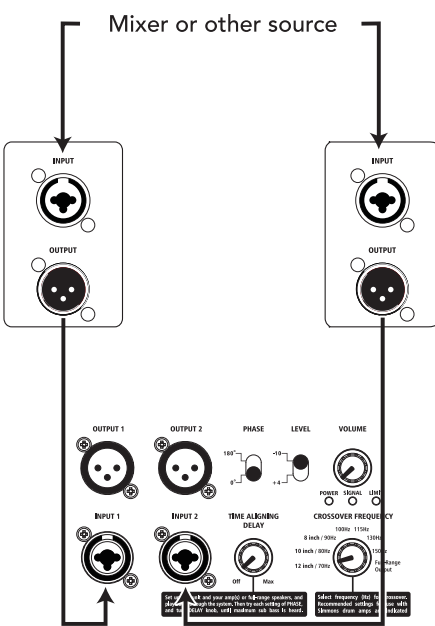

Feeding Simmons Smart Stereo drum amps

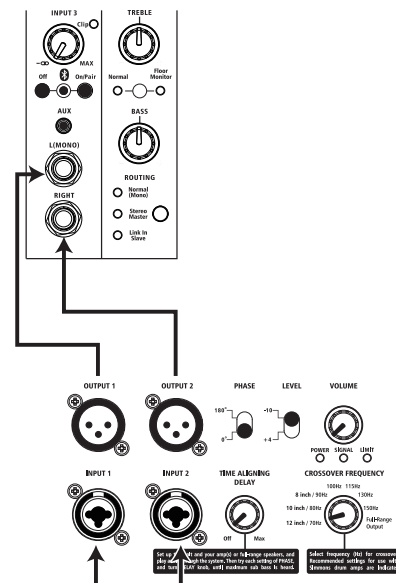

Mixer or other source

DA12S BACK PANEL

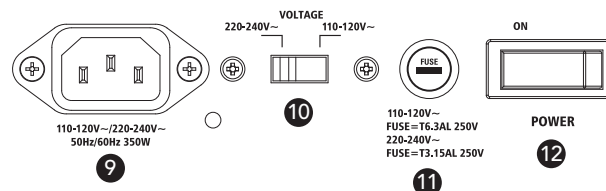
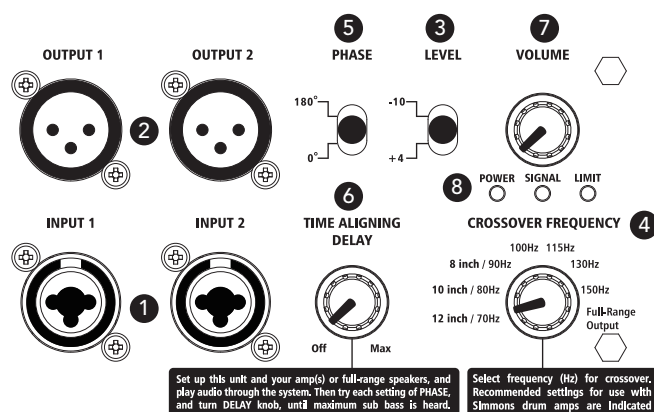

1 INPUTS 1 AND 2

These combo inputs are designed for either TRS or XLR balanced plugs at line level, either from a mixer or another speaker. The source can be either mono or stereo.

2 OUTPUTS 1 AND 2

These outputs feed through the signal(s) received from the input(s). If the crossover is not set to Full-Range Output, the output signal(s) will be altered by the crossover, which removes audio below the selected frequency, to allow your amplifiers or speakers that are fed by the sub to focus all their energy and fidelity on reproducing signals above the selected frequency.

3 LEVEL SWITCH

Set this switch to match the output level of your source:

- Use +4 when your source operates at +4dBu
- Use -10 when your source operates at -10dBV

If you notice that the rear panel LIMIT LED or front panel LED is easily or frequently lit red, even when you have the LEVEL knob turned to a low setting, set this switch to +4 rather than -10.

4 CROSSOVER

This knob controls the high precision DSP crossover. Select a value between 70 and 150Hz to have the audio below the selected frequency filtered out of the output signals. Select Full-Range Output to disable the crossover, and output the same full range audio received at the outputs. The audio sent to the internal power amp and speaker will also be filtered, so the subwoofer's speaker produces only audio below the crossover frequency. When Full-Range Output is chosen, the subwoofer's speaker limits its top frequency range to 150Hz.

5 PHASE

This switch lets you "flip" (reverse) the phase on the power amp 180 degrees when needed to match the polarity of amplifiers or speakers that may operate with opposite polarity to the DA12S, or to account for a phase difference due to the physical distance between the sub and the full range speakers it is operating with. When set to 0, phase is unaffected. When set to 180, the phase of the power amp and internal speaker will be reversed. Once you get your S12 operating as part of your full setup with your full-range speakers, try both settings of this switch, and leave the switch on the setting that provides the most low frequency impact.

6 TIME ALIGNING DELAY

After you've set up your system including the DA12S subwoofer and your full-range amplifiers or speakers, and are playing audio through the system to evaluate the low frequency response, set the PHASE switch for maximum low frequency impact, and then turn this knob until maximum sub bass is heard.

7 VOLUME KNOB

Sets volume of internal speaker.

8 LEDS

- POWER: this LED and front LED will light white when power is on.
- SIGNAL: this LED lights green when audio input is detected.
- LIMIT: this LED and front LED light red when limiter is activated due to very high level audio input, indicating the VOLUME knob should be turned down to avoid distorted sound. If the LIMIT LED comes on when the VOLUME knob is already at a low level, try setting the LEVEL switch to +4.

9 IEC POWER INPUT

Plug in the IEC AC power cable here.

10 VOLTAGE SELECTOR

Configures DA12S for your territory's voltage. 110-120V is the standard in the USA.

11 FUSE CARRIER

If the DA12S will not power on and you suspect its fuse may have blown, turn off the power switch, and open the fuse compartment using a small flat blade screwdriver. If metal strip in fuse is broken, replace with T6.3AL 250V fuse for 110-120 volt operation, or T3.15AL 250V for 220-240 volt operation.

12 POWER SWITCH

Turns the DA12S subwoofer on or off.

SPECIFICATIONS

Smart Stereo	A matching pair of DA2100 series amplifiers can be connected via a standard microphone cable, for unified volume and tone control from the first master amplifier, with optimal distribution of mono and stereo audio signals between both amplifiers, for immersive high-fidelity stereo sound		
Floor/Pole Switch	Configures amplifier for consistent frequency response whether used on the floor, or on a speaker pole		
Rear Panel Inputs (1/2/3)	Left/mono and right 1/4-inch TRS balanced/unbalanced compatible audio line inputs		
Bluetooth Audio Input	Bluetooth 5.0 Stereo Audio Input, with On/Pair and Off buttons plus LED		
Front Panel Aux Input	1/8-inch mini TRS unbalanced input		
Link In Jack	XLR balanced +4dBv audio input		
Link Out Jack	XLR balanced +4dBv audio output		
Direct Out Jack	XLR balanced +4dBv audio output		
Power LED	Front panel white LED indicates power on		
Clip LED	Front panel red LED indicates power amp clipping		
Power Cable	Detachable IEC 3-connector USA standard		
Power Input	Switchable: 110-120V/60 Hz or 220-240V/50Hz		
Cabinet	Polypropylene		
Grille	1.2mm steel		
Speaker Pole Socket	35mm (1.35-inch) standard socket for speaker pole mounting (speaker pole not included)		
Suspension Points	DA2100 Series Units Are Not Designed For Suspension		
	DA2108	DA2110	DA2112
Power Consumption	100W		400W
Power Output	100 Watts RMS 400 Watts Peak		350 Watts RMS 2000 Watts Peak
Headphone Output	3.5mm Stereo Jack Silences speakers when connected		3.5mm Stereo Jack Dedicated volume control knob
Input 3 Routing	Not included		To facilitate click track, metronome and backing track use in performance, input 3 can be routed to phones only, phones and speakers only, or phones, speakers and direct out
EQ Knobs	Lows: +/-12dB @ 75Hz Highs: +/-12dB @ 10KHz	Lows: +/-12dB @ 75Hz Mids: +/-12dB @ 1KHz Highs: +/-12dB @ 10KHz	Lows: +/-12dB @ 65Hz Low Mids: +/-12dB @ 350Hz High Mids: +/-12dB @ 2.5KHz Highs: +/-12dB @ 10KHz
Volume/Level Knobs	Input 1 Level knob Bluetooth/Aux Level knob	Input 1 Level knob Input 2 Level knob Bluetooth/Aux Level knob	Input 1 Level knob Input 2 Level knob Input 3 Level knob Bluetooth/Aux Level knob Master Volume knob Headphone Volume knob
Speaker Drivers	8-inch Low Frequency driver 1-inch Compression driver	10-inch Low Frequency driver 1-inch Compression driver	12-inch Low Frequency driver 1.35-inch Compression driver
Frequency Response	65-20K Hz	55Hz-20KHz	40Hz-20KHz
Max SPL@1M	118dB	120dB	126dB
Product Dimensions	17.25"W x 10.25"H x 10.1"D	20"W x 11.8"H x 11.45"D	24.1"W x 14.2"H x 14.2"D
Packaging Size	20.1"W x 13.4"H x 13.4"D	22.85"W x 15"H x 15"D	28.1"W x 18.1"D x 18.1"D
Net Weight	15.5 pounds	20 pounds	38.5 pounds
Gross Weight	19 pounds	24 pounds	45 pounds

SPECIFICATIONS

	DA125	
Amplifier	Inputs	2 XLR / TRS LINE input
	Outputs	2 XLR line output
	Power Output	400 watts RMS @ 4 Ohms / 1000 watts Peak
	Volume	Main volume control
	Power Input	110-120V, 220-240V, 50-60Hz, 350w power draw
	Other Features	Class D+ switching power design
		Front LED indicates power (white) and limiter (red)
		Rear panel power (white), signal (green), and limiter (red) LEDs
		High precision digital crossover, adjustable from 70-150Hz, or full-range output
		Time Aligning Delay, to easily optimize bass response in any setup
		Phase switch, select 0 or 180 degrees
		Transparent, dynamic DSP limiter
Speaker	Type	Active vented subwoofer
	Frequency Response	35-150Hz
	Max Output SPL@1M	130dB
	Impedance	4 Ohm
	Woofers	12" subwoofer
	Cabinet	Plywood with black Polyurea painted finish
	Grille	1.5mm steel
	Pole	35mm stand pole
	Features	Rubber feet
Dimensions and Weights	Unit Size	D: 18.1" x W: 14.6" x H: 17.2" (including feet)
	Package Size	D: 21.7" x W: 18.1" x H: 20.1"
	Unit Weight	46.2 pounds
	Package Weight	52.8 pounds

IMPORTANT SAFETY INSTRUCTIONS

Please keep this instruction manual for future reference and for the duration of owning your Simmons DA2100 Series Advanced Electronic Drum Amplifier. Please carefully read and understand the instructions inside this owner's manual before attempting to operate your new amplifier.

This instruction manual includes essential safety information regarding the use and maintenance of the amplifier. Take special care to heed all warning symbols and signs inside this manual and those printed on the amplifier panel on the back of the unit.

WARNING

TO PREVENT FIRE OR SHOCK HAZARD, DO NOT EXPOSE THE AMPLIFIER TO WATER/MOISTURE, NOR SHOULD YOU OPERATE THE AMPLIFIER NEAR ANY WATER SOURCE.

The exclamation point triangular symbol is intended to alert the user to the presence of important operating and maintenance(servicing) instructions in the user manual accompanying the Amplifier.

The lightning flash with an arrow triangular symbol is intended to alert the user to the presence of non-insulated "dangerous voltage" within the product's enclosure, and may be of sufficient magnitude to constitute a risk of electric shock.

WARNING

Handle the power supply cord with care.

Do not damage or deform it as it may cause electric shock or malfunction when used. Hold the plug attachment when removing from wall outlet. Do not pull on the power cord.

IMPORTANT SAFETY PRECAUTIONS

1. Read these instructions.
2. Keep these instructions.
3. Heed all warnings.
4. Follow all Instructions.
5. Do not use this apparatus near water.
6. Clean only with dry cloth.
7. Do not block any ventilation openings. Install in accordance with the manufacturer's instructions. DO NOT turn on the amplifier module before connecting all other external devices.
8. Do not install near any heat sources such as radiators, heat registers, stoves, or other apparatus (including amplifiers) that produce heat.
9. Do not defeat the safety purpose of the polarized or grounding-type plug. A polarized plug has two blades with one wider than the other. A grounding type plug has two blades and a third grounding prong. The wide blade or the third prong is provided for your safety. If the provided plug does not fit into your outlet, consult an electrician for replacement of the obsolete outlet.
10. Protect the power cord from being walked on or pinched particularly at plugs, convenience receptacles, and the point where they exit from the apparatus.
11. Only use attachment/accessories specified by the manufacturer.
12. Use only the cart, stand, tripod, bracket or table specified by the manufacturer, or sold with the apparatus. When a cart is used, use caution when moving the cart/apparatus combination to avoid injury from tip-over.
13. Unplug this apparatus during lightning storms or when unused for long periods of time.



14. Refer all servicing to qualified service personnel. Servicing is required when the apparatus has been damaged in any way, such as power-supply cord or plug is damaged, liquid has been spilled or objects have fallen into the apparatus, the apparatus has been exposed to rain or moisture, does not operate normally, or has been dropped.
15. **POWER SOURCES** – This product should be operated only from the type of power source indicated on the rating label. If you are not sure of the type of power supply to your home, consult your product dealer or local power company.
16. **WALL OR CEILING MOUNTING** – The product should never be mounted to a wall or ceiling.
17. Where the mains plug or an appliance coupler is used as the disconnect device, the disconnect device shall remain readily operable.
18. **OBJECT AND LIQUID ENTRY** – Care should be taken so that objects do not fall and liquids are not spilled into the enclosure through openings.
19. **Water and Moisture:** This product should be kept away from direct contact with liquids. The apparatus shall not be exposed to dripping or splashing and that no objects filled with liquids, such as vases, shall be placed on the apparatus.
20. Keep the product out of extended or intense direct sun light.
21. No containers filled with any type of liquid should be placed on or near the product.
22. **SERVICING** – The user should not attempt any service to the speaker and/or amplifier beyond that described in the operating instructions. All other servicing should be referred to qualified service personnel.
23. **VENTILATION** – Slots and openings in the amplifier are provided for ventilation and to ensure reliable operation of the product and to protect it from overheating. These openings must not be blocked or covered. The openings should never be blocked by placing the product on a bed, sofa, rug, or other similar surface. This product should not be placed in a built-in installation such as a bookcase or rack.
24. **Protective earthing terminal:** The apparatus should be connected to a main socket outlet with a protective earthing connection.
25. **ACCESSORIES** – Do not place this product on an unstable cart, stand, tripod, bracket, or table. The product may fall, causing serious injury to a child or adult, and serious damage to the product. Use only with a cart, stand, tripod, bracket, or table recommended by the manufacturer, or sold with the product.
26. When moving or not using the appliance, secure the power cord (e.g., wrap it with a cable tie). Be careful not to damage the power cord. Before using it again, make sure the power cord has not been damaged. If the power cord has been damaged at all, bring the unit and cord to a qualified service technician for repair or replacement as specified by the manufacturer.
27. **LIGHTNING** – For added protection during a lightning storm, or when it is left unattended and unused for long periods of time, unplug it from the wall outlet. This will prevent damage to the product due to lightning and power-line surges.
28. **REPLACEMENT PARTS** – When replacement parts are required, be sure the service technician has used replacement parts specified by the manufacturer or parts that have the same characteristics as the original parts. Unauthorized substitutions may result in fire, electric shock, or other hazards.



IMPORTANT SAFETY INSTRUCTIONS

To prevent electric shock, do not use a polarized plug with an extension cord, receptacle or other outlet unless the blades can be fully inserted to prevent blade exposure.



CAUTION
RISK OF
ELECTRIC SHOCK
DO NOT OPEN

AVIS
RISQUE DE CHOC
ELECTRIQUE NE
PAS OUVRIR



CAUTION: To reduce the risk of electric shock, do not remove chassis. No user-serviceable parts inside. Refer servicing to qualified service personnel.

AVERTISSEMENT: Pour réduire les risques d'incendie et d'électrocution, ne pas exposer ce matériel à la pluie ou à l'humidité.



THIS SYMBOL IS INTENDED TO ALERT THE USER TO THE PRESENCE OF IMPORTANT OPERATING AND MAINTENANCE (SERVICING) INSTRUCTIONS IN THE LITERATURE ACCOMPANYING THE UNIT.



APPARATUS SHALL NOT BE EXPOSED TO DRIPPING OR SPLASHING AND THAT NO OBJECTS FILLED WITH LIQUIDS, SUCH AS VASES, SHALL BE PLACED ON THE APPARATUS.

HEARING DAMAGE AND PROLONGED EXPOSURE TO EXCESSIVE SPLs

Simmons Advanced Drum Amplifiers are capable of producing extremely loud volume levels that can cause permanent hearing damage to performers, production crews or the audience. Hearing protection is recommended during long-term exposure to high SPLs (sound pressure levels).

Remember, if it hurts, it is definitely too loud! Long term exposure to high SPLs first causes temporary threshold shifts; limiting your ability to hear the actual loudness and exercise good judgment. Repeated long term exposure to high SPLs will cause permanent hearing loss.

Please note the recommended exposure limits in the accompanying table. More information about these limits is available on the US government Occupational Safety and Health (OSHA) website at: www.osha.gov.

Permissible Noise Exposures (1)

Duration per day, hours	Sound level dBA slow response
8	90
6	92
4	95
3	97
2	100
1.5	102
1	105
0.5	110
0.25 or less	115

WARRANTY

Two (2) Years limited warranty

Subject to the limitations set forth below, Simmons® hereby represents and warrants that the components of this product shall be free from defects in workmanship and materials, including implied warranties of merchantability or fitness for a particular purpose, subject to normal use and service, for two (2) years to the original owner from the date of purchase.

Retailer and manufacturer shall not be liable for damages based upon inconvenience, loss of use of product, loss of time, interrupted operation or commercial loss or any other incidental or consequential damages including but not limited to lost profits, downtime, goodwill, damage to or replacement of equipment and property, and any costs of recovering, reprogramming, or reproducing any program or data stored in equipment that is used with Simmons® products. This guarantee gives you specific legal rights. You may have other legal rights which vary from state to state. Some states do not allow limitations on how long an implied warranty lasts, so the above limitation may not apply to you.

Simmons
P.O. Box 5111 Thousand Oaks, CA 91359-5111

All trademarks and registered trademarks mentioned herein are recognized as the property of their respective holders.

FCC STATEMENT

1. Caution: Changes or modifications to this unit not expressly approved by the party responsible for compliance could void the user's authority to operate the equipment.
2. Note: This equipment has been tested and found to comply with the limits for a Class B digital device, pursuant to part 15 of the FCC Rules. These limits are designed to provide reasonable protection against harmful interference in a residential installation. This equipment generates, uses and can radiate radio frequency energy and, if not installed and used in accordance with the instructions, may cause harmful interference to radio communications. However, there is no guarantee that interference will not occur in a particular installation. If this equipment does cause harmful interference to radio or television reception, which can be determined by turning the equipment off and on, the user is encouraged to try to correct the interference by one or more of the following measures:
 - Reorient or relocate the receiving antenna.
 - Increase the separation between the equipment and receiver.
 - Connect the equipment into an outlet on a circuit different from that to which the receiver is connected.
 - Consult the dealer or an experienced radio/ TV technician for help.

Warning: Changes or modifications to this unit not expressly approved by the party responsible for compliance could void the user's authority to operate the equipment.

FCC Radiation Exposure Statement

The device has been evaluated to meet general RF exposure requirements. The device can be used in a fixed/mobile (min 20cm) exposure condition without restriction.



OR VISIT OUR WEBSITE AT: SIMMONSDRUMS.NET