

# SIMMONS<sup>®</sup>

The first name in electronic drums.

## SD100<sup>0</sup>KIT

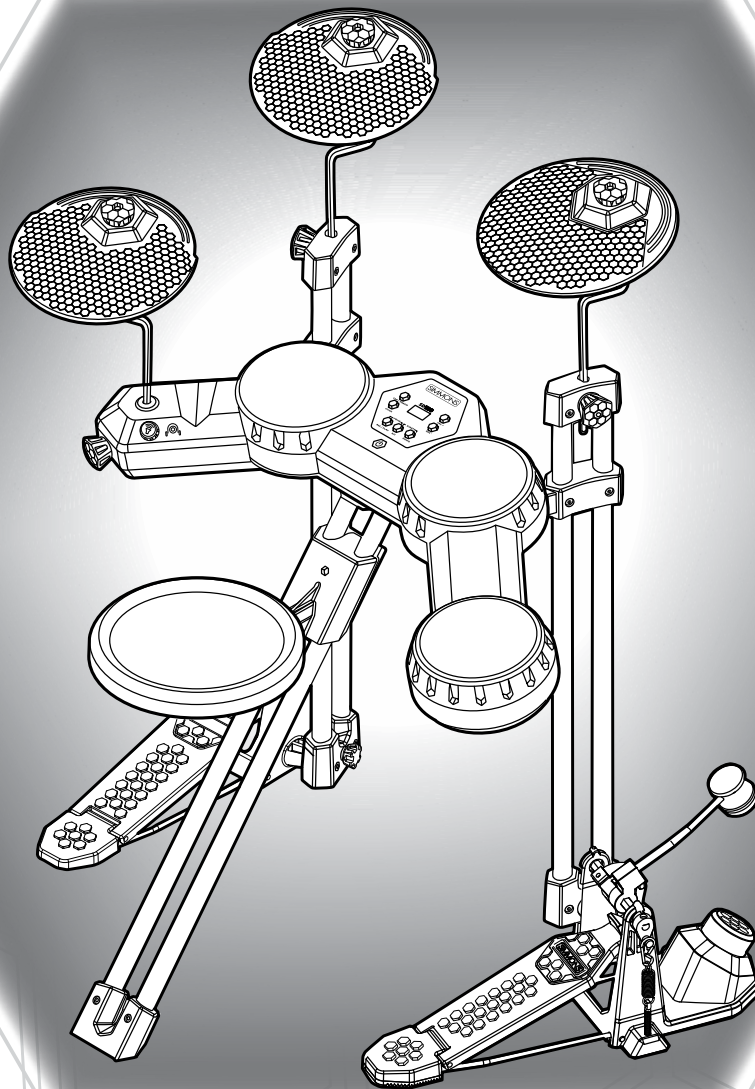

## Electronic Drum Kit

## OWNER'S MANUAL

[www.SimmonsDrums.net](http://www.SimmonsDrums.net)

# SAFETY INSTRUCTIONS

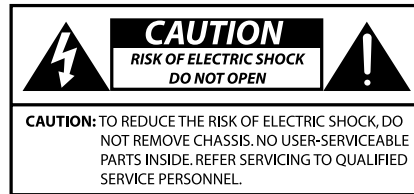

*AVIS: RISQUE DE CHOC ELECTRIQUE-NE PAS OUVRIR.*



THE LIGHTNING FLASH WITH ARROWHEAD SYMBOL WITHIN AN EQUILATERAL TRIANGLE IS INTENDED TO ALERT THE USER TO THE PRESENCE OF UNINSULATED DANGEROUS VOLTAGE WITHIN THE PRODUCTS ENCLOSURE THAT MAY BE OF SUFFICIENT MAGNITUDE TO CONSTITUTE A RISK OF ELECTRIC SHOCK TO PERSONS.



THE EXCLAMATION POINT WITHIN AN EQUILATERAL TRIANGLE IS INTENDED TO ALERT THE USER TO THE PRESENCE OF IMPORTANT OPERATING AND MAINTENANCE(SERVICING) INSTRUCTIONS IN THE LITERATURE ACCOMPANYING THE PRODUCT.



APPARATUS SHALL NOT BE EXPOSED TO DRIPPING OR SPLASHING AND THAT NO OBJECTS FILLED WITH LIQUIDS, SUCH AS VASES, SHALL BE PLACED ON THE APPARATUS.

- 1) Read these instructions.
- 2) Keep these instructions.
- 3) Heed all warnings.
- 4) Follow all instructions.
- 5) Do not use this apparatus near water.
- 6) Clean only with dry cloth.
- 7) Do not block any ventilation openings. Install in accordance with the manufacturer's instructions.
- 8) Do not install near the heat sources such as radiators, heat registers, stoves, or other apparatus (including amplifiers) that produce heat.
- 9) Do not defeat the safety purpose of the polarized or grounding-type plug. A polarized plug has two blades with one wider than the other. A grounding type plug has two blades and a third grounding prong. The wide blade or the third prong are provided for your safety, if the provided plug does not fit into your outlet, consult an electrician for replacement of the obsolete outlet.
- 10) Protect the power cord from being walked on or pinched particularly at plugs convenience receptacles, and the point where they exit from the apparatus.
- 11) Only use attachments/accessories specified by the manufacturer.
- 12) Unplug this apparatus during lightning storms or when unused for a long periods of time.
- 13) Refer all servicing to qualified service personnel. Servicing is required when the apparatus has been damaged in any way, such as power-supply cord or plug is damaged, liquid has been spilled or objects have fallen into the apparatus, the apparatus has been exposed to rain or moisture, does not operate normally, or has been dropped.

**WARNING:** To reduce the risk of fire or electric shock, do not expose this apparatus to rain or moisture.

**CAUTION:** Apparatus shall not be exposed to dripping or splashing and no objects filled with liquids, such as vases, shall be placed on the apparatus.

# TABLE OF CONTENTS

---

<b>Safety Instructions</b>	<b>2</b>
<b>Assembled Kit</b>	<b>4</b>
<b>Panel Controls</b>	
Top Panel	5
LED Display	5
Rear Panel	6
<b>Assembly Instructions</b>	<b>7, 8</b>
<b>Connections</b>	
Connecting the Pads	9
Connecting the Power Supply	10
Connecting CD/MP3 Player	10
Connecting USB MIDI	10
Connecting Headphones	10
<b>Getting Started</b>	
Switching Power On	11
Setting the Volume	11
Selecting Drum Kits	11
The [KIT] Button	11
Selecting a Voice	12
The [CLICK] Button	12
The [REC/PLAY] Button	13
The [SONG] Button	13
The [TEMPO/TAP] Button	14
<b>Factory Settings</b>	<b>15</b>
<b>Drum Kit Presets</b>	
Preset Drum Kit List	16
Song Style List	16
Drum Sound List	17
<b>MIDI Implementation Chart</b>	<b>18</b>
<b>Specifications</b>	<b>19</b>
<b>Warranty</b>	<b>19</b>

# ASSEMBLED KIT

---

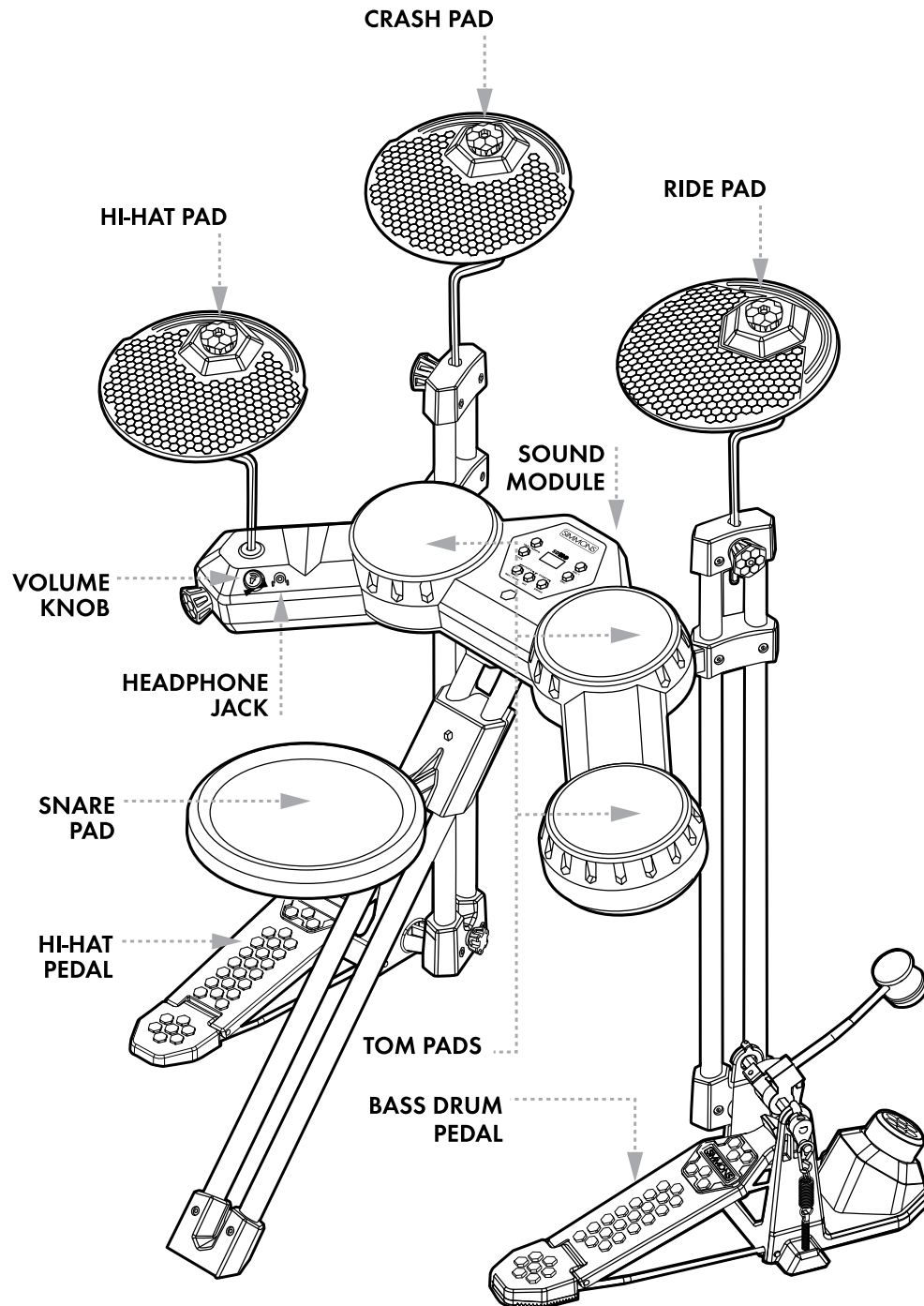

# PANEL CONTROLS

## Top Panel

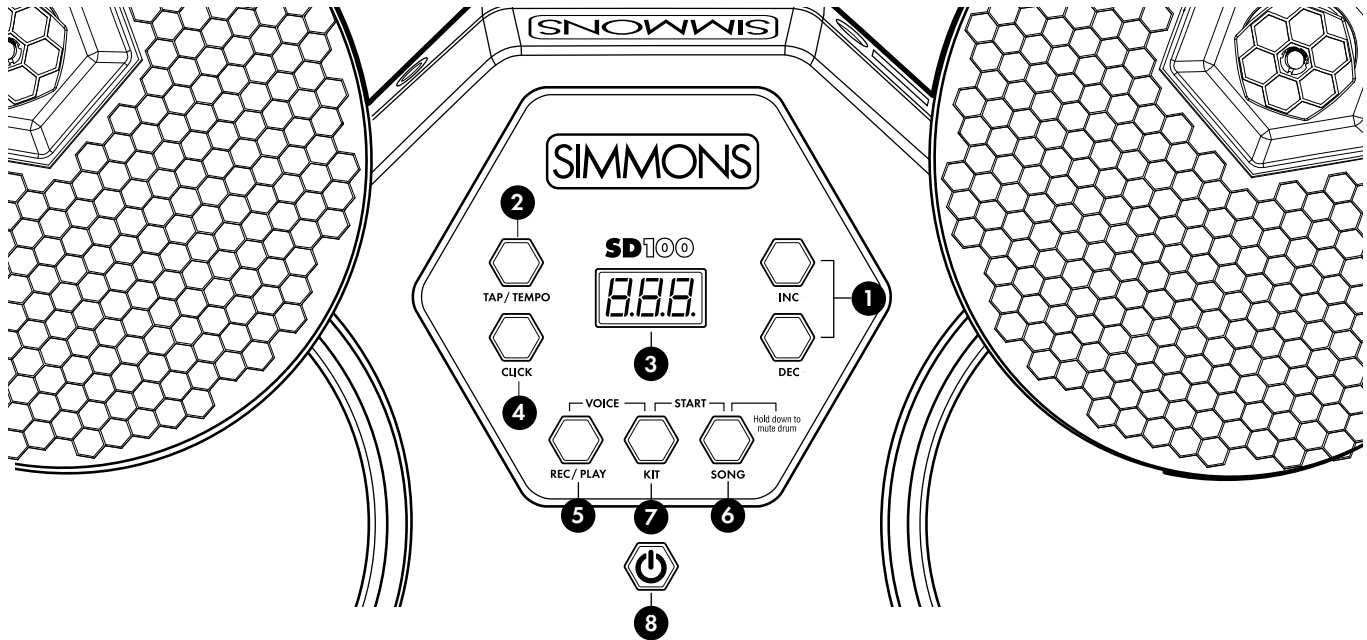

### ① [+]/[-] Value Control Buttons

Use these buttons to navigate through the 10 drum kits, switch menu selections, or change parameter values.

### ② [TEMPO/TAP] Button

Adjusts the tempo of the built-in metronome, the practice songs, or the song you are recording. You can also set the tempo by tapping this button repeatedly.

### ③ LED Display

Takes you to the mode where you are able to change the kit, song and voice.

### ④ [CLICK] Button

Turns the metronome on and off at any time. It's also used to change the click settings such as time signature and click volume.

### ⑤ [REC/PLAY] Button

Gives you the option to record or play back your own performance.

### ⑥ [SONG] Button

Enters the song select display. You can mute the drum part and adjust the song's volume. See page 14.

### ⑦ [KIT] Button

Enters the kit selection.

### ⑧ ON/OFF Button

## LED Display

The LED indicates the SONG, PAD or KIT status. When SONG is selected, the song number appears in the display. When PAD is selected, the pad name such as Snare, Crash, and Tom, etc. will appear. Press the KIT button and the drum kit number will be displayed on the LED.

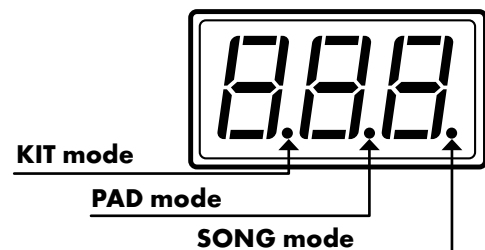

# PANEL CONTROLS

## Rear Panel

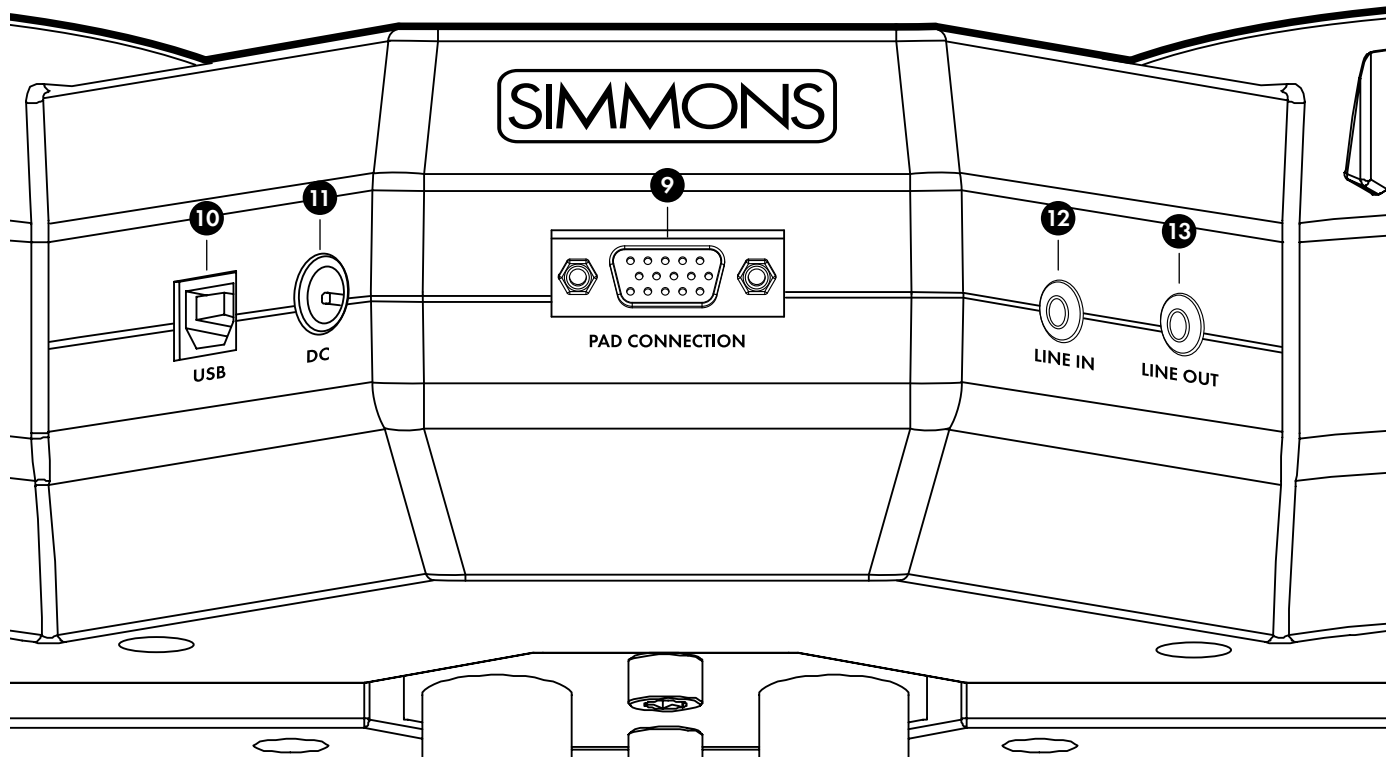

**9 Pad Connection**

Control cable connects the pads and the pedals to the module.

**10 USB**

Connect to a computer for two-way MIDI communication. This will enable a software program to trigger the drum module sounds, or allow you to use the module as a MIDI trigger interface for the software's virtual drum instruments.

**11 DC**

Connect the AC adapter cable to an outlet to run power to the SD100KIT.

**12 Line In**

You can connect the output of an external audio device to this jack. (stereo 3.5mm). This is convenient for playing along with music from a CD or MP3 player.

**13 Line Out**

Use this output to connect to external speakers or a mixing board (stereo 3.5 mm).

# ASSEMBLY INSTRUCTIONS

## Step 1:

Remove the pad/module from the packing. Attach the front steel tube unit to the pad/module with 2 provided screws and tighten. (For better leverage and visibility, you may want to complete this step with module/pad turned upside down).

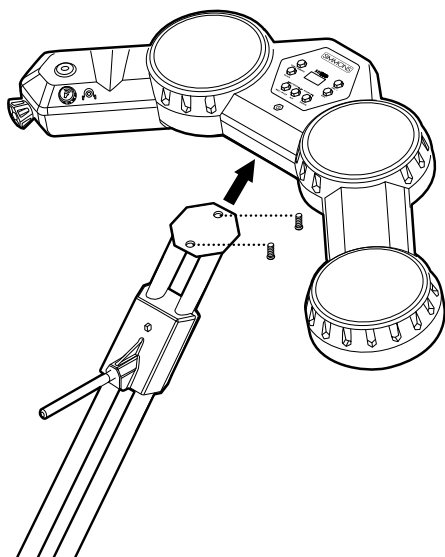

## Step 2:

Insert the back steel drum legs into the pad/module securely as shown, and tighten each with the provided screws.

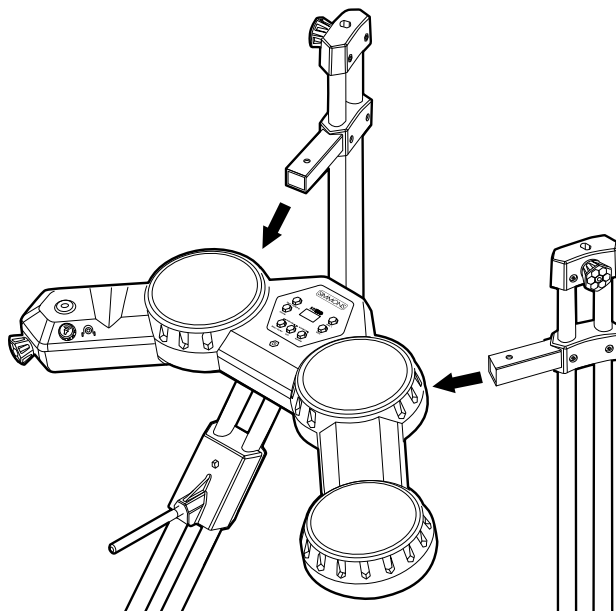

## Step 3:

Insert the snare pad onto the snare rod mount as shown, and tighten the wingnut.

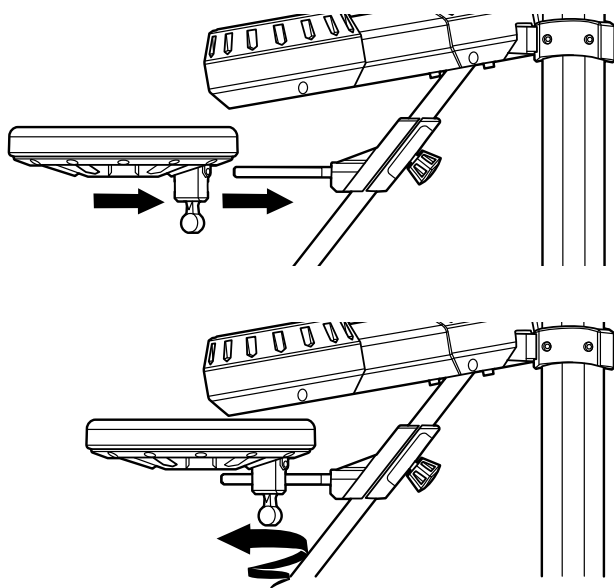

## Step 4:

Insert the cymbal L-arm mounts into their respective holes as shown and tighten each of the hex wingnuts. Use large knob on the left to tighten the arm mount.

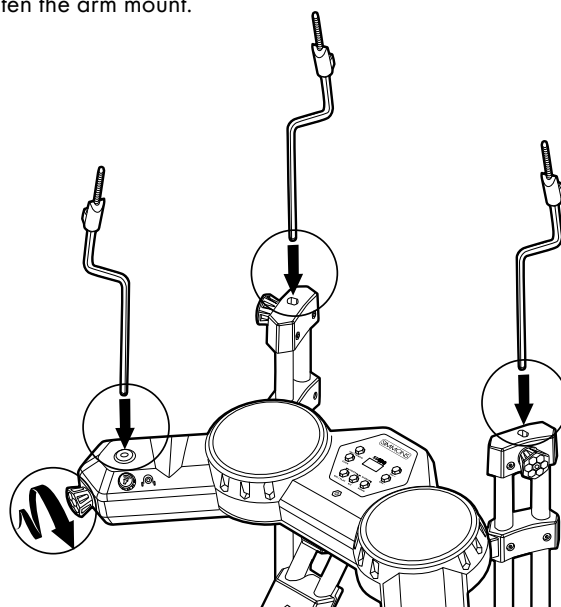

# ASSEMBLY INSTRUCTIONS

## Step 5:

Assemble hi-hat, crash and ride cymbal pads as shown and tighten the hex wingnuts.

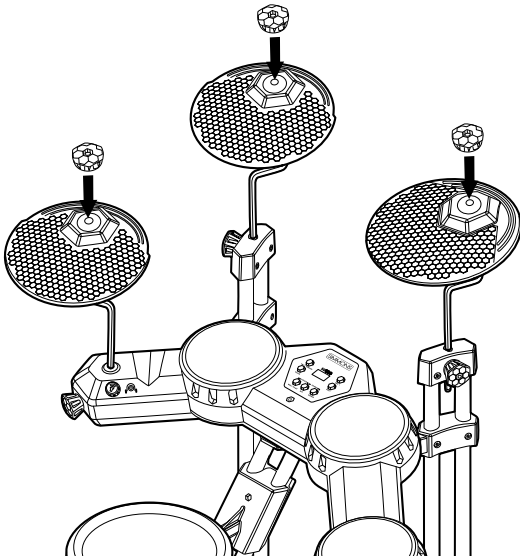

## Step 6:

Locate the kick drum pedal and insert into bottom of right leg. Tighten with hex wingnut screw.

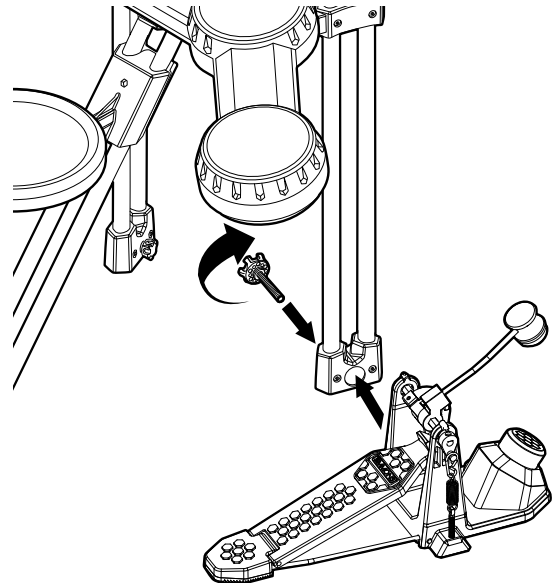

## Step 7:

Locate the hi-hat drum pedal and insert into bottom of left leg. Tighten with hex wingnut screw.

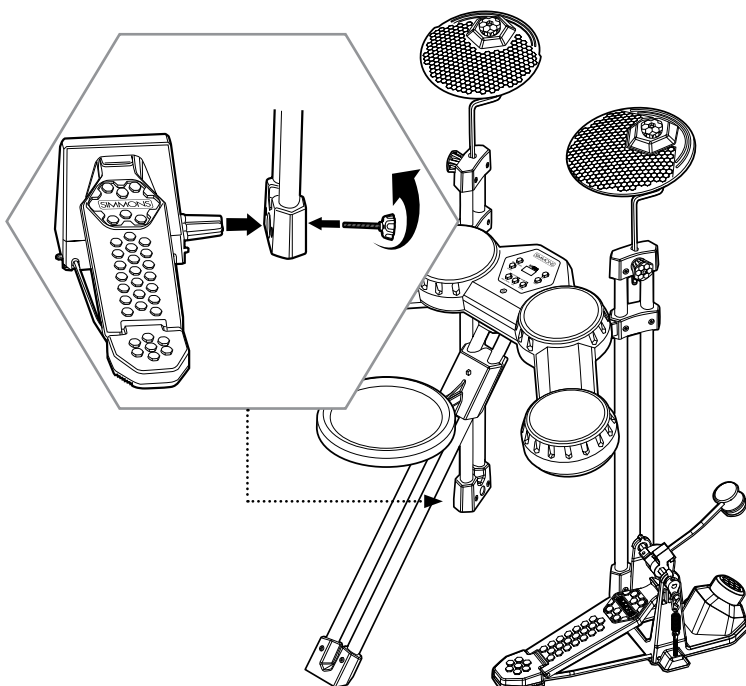

## Step 8:

Assembly complete. C

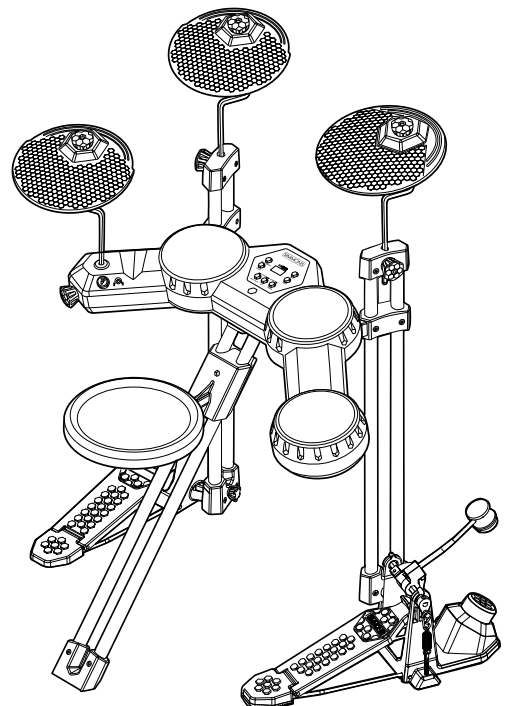



# CONNECTIONS

## Connecting the Pads

With the drum kit set up correctly, next connect the multi-pin cable into the pad connection port on back panel of module as shown. Then connect each of the labeled cables into their respective inputs. (Each cable is labeled as the cables can vary in length and type.)

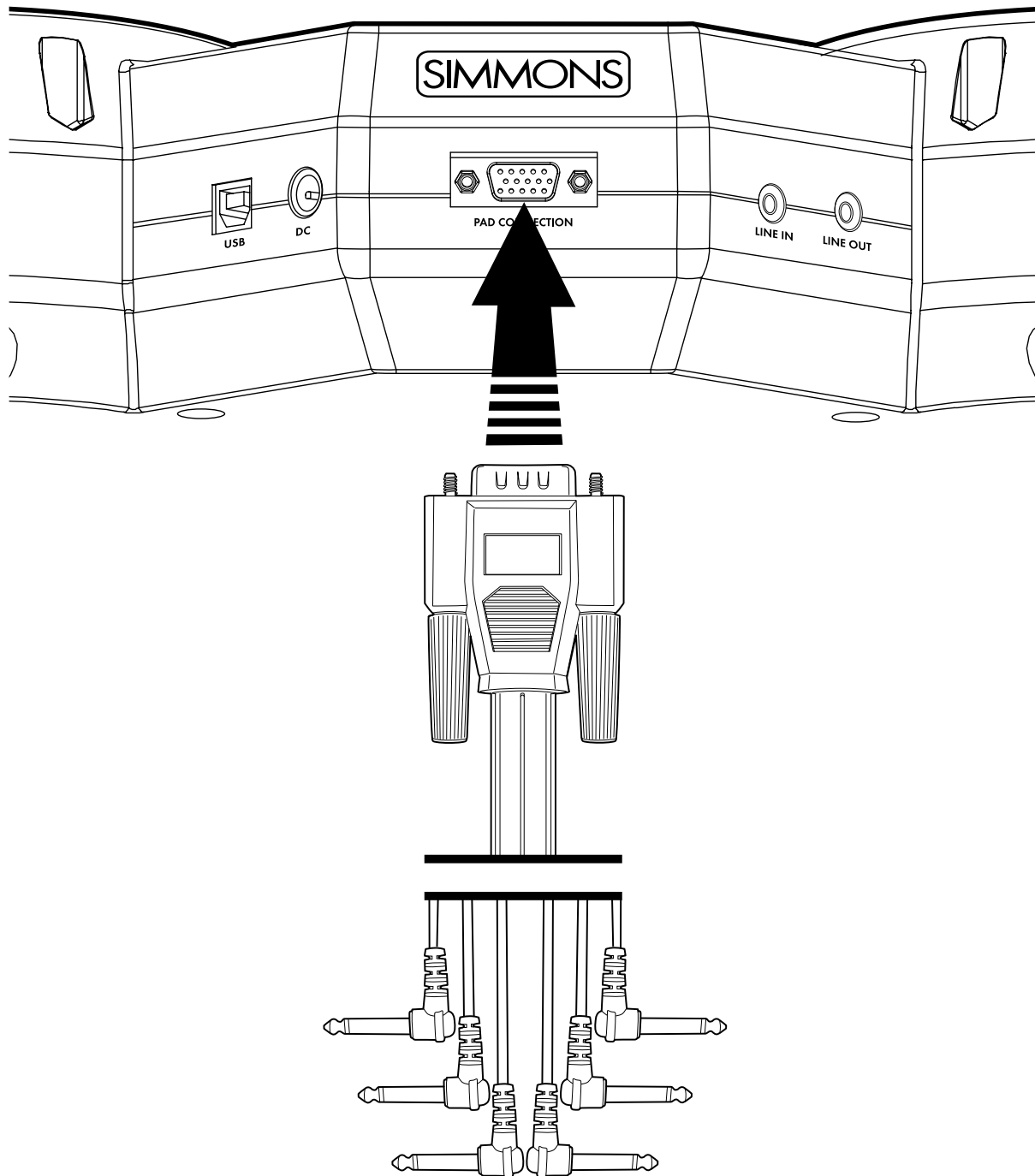

## CONNECTIONS

### Connecting the Power Supply

Connect the AC power adapter to a wall socket as shown at right.

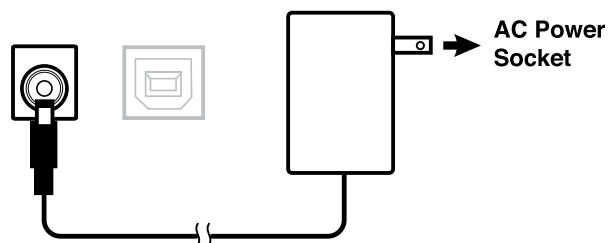

### Connecting CD/MP3 Player

The audio output from a CD/MP3 player connected to the LINE-IN jack on the rear panel can be mixed with the sound of the drum module. This is ideal if you want to play along with songs or follow an audio drum tutorial.

The volume of the external signal is adjusted with the MASTER VOLUME knob.



### Connecting USB MIDI

Your drum module is USB class-compliant. This means you can plug it into a USB class compliant host (for example, a computer running OS X, Windows XP, Vista or Windows 7) and it should be recognized immediately. There are no drivers to install; simply plug n' play.

If you connect the drum module to a computer, you can trigger software programs or record your performance into a MIDI sequencing application. Check the operation and setup instructions for the software you intend to use for more details.

*USB cable not included.*

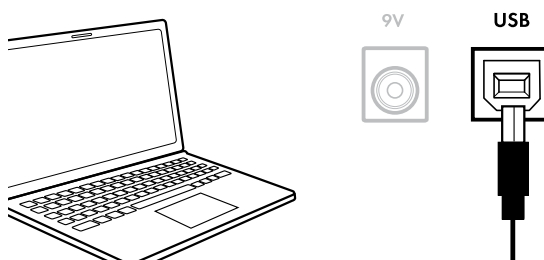

### Connecting Headphones

Your headphones can be connected to the SD100KIT. The headphone jack is located on the left side of module base under the Hi-Hat Pad. Use the MASTER VOLUME knob to adjust the headphone volume.

HEADPHONE OUT



# GETTING STARTED

## Switching the Power On

Locate the ON/OFF power button on the drum module and switch the power ON. The drum module is ready to operate when the display shown to the right appears. This is the location from which you select the drum kit you want to play or edit.

Power saving option: Your SD100KIT will automatically turn off after 30 minutes of non use. (See page 15 for reference)

**SON = Power saving ON. SOF = Power saving OFF.**  
(Factory default should be set to OFF)

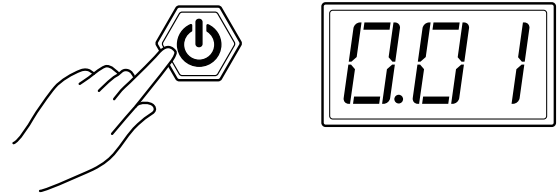

## Setting the Volume

Use the MASTER VOLUME knob to adjust the volume.

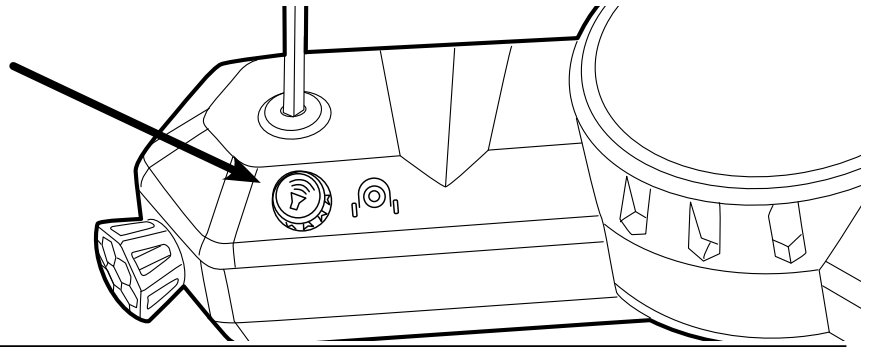

## Selecting Drum Kits

Press the [KIT] button. The current kit number will appear and you can use the [+] or [-] buttons to select kits ranging from: 001-010, USER. In the USER kit location you can store your own settings for recall later.

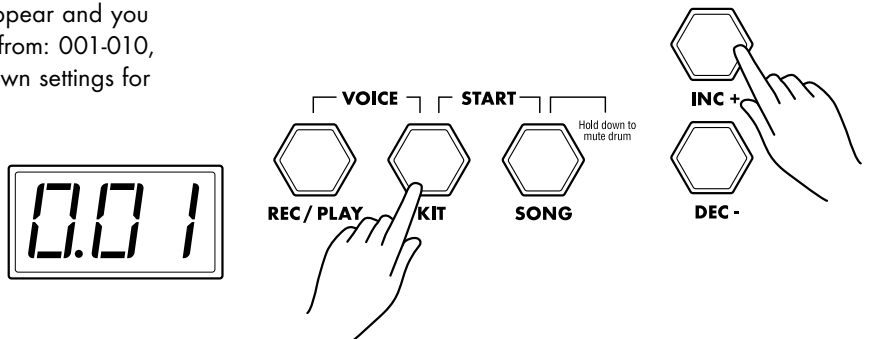

## The [KIT] Button

Press the [KIT] button and press the [+] or [-] button to adjust the volume of pads. Range: 0-127. Select a pad by hitting it.

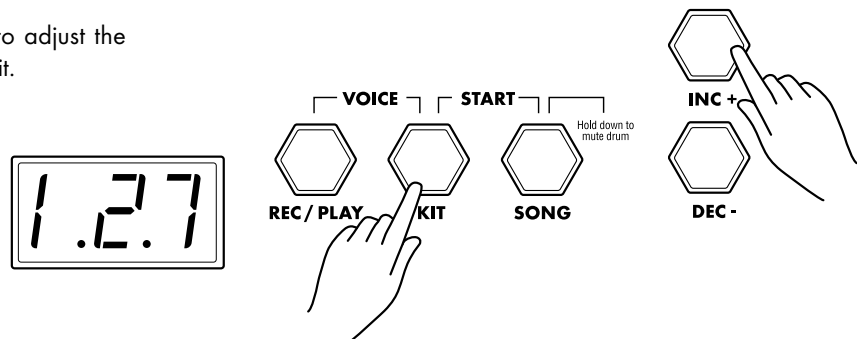

# GETTING STARTED

## Selecting A Voice

Press the [KIT] and [REC/PLAY] buttons simultaneously, then hit a pad that you want to change the voice for and use the [+] or [-] buttons to select the voice.

For example: to select a TOM1 voice, press the [KIT] and [REC/PLAY] buttons. The LED will display the current drum number. Hit the TOM1 and the LED displays as shown to the right, then the LED displays TOM1 instrument.

Hit another pad to select and use the [+] or [-] buttons to select the Voice. You also can press the [CLICK] button to listen to the voice. Finally press the [REC/PLAY] button to save your settings in the user kit.

Press any other button to exit the menu.

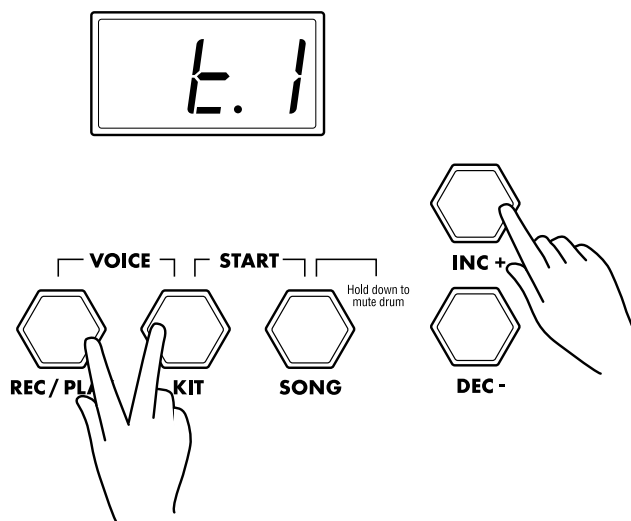

## The [CLICK] Button

### Click Type

Press [CLICK] button for 2 seconds to enter the metronome type choice, use [+/-] to select click type: 1/4, 2/4, 3/4, 4/4, 6/4, 3/8, 6/8, 12/8. default: 4/4.

### Click Sound

When click is on, press and hold the [CLICK] button and use [+] or [-] buttons to select the click sound. You have 3 sound options: 001-003.

### Click Volume

When click is OFF, press and hold the [CLICK] button and use [+] or [-] buttons to select click volume, range: 000-032.

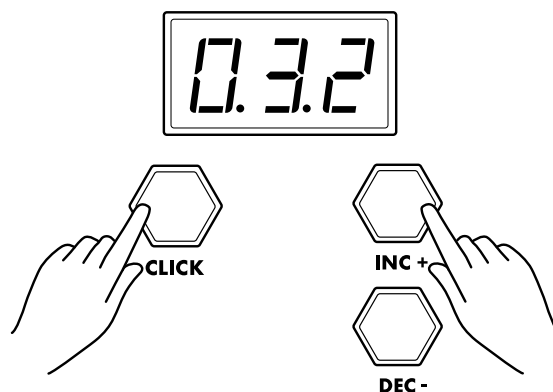
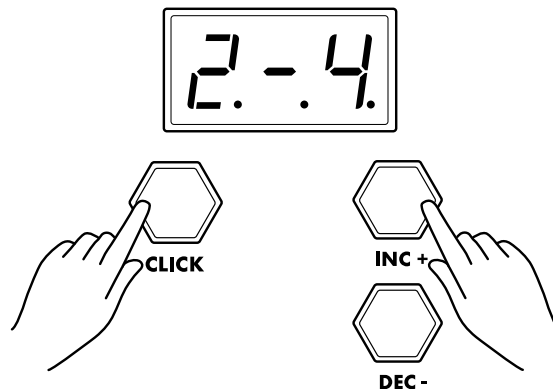

# GETTING STARTED

## The [REC/PLAY] Button

### Recording

Press and hold the [REC/PLAY] button for **2 seconds**. Recording will start after you hear one bar of metronome hits.

Press [REC/PLAY] button again to stop recording.

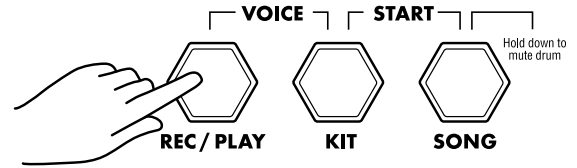

### Play Back the Recording

Press the [REC/PLAY] button to play back your recording. Press the [REC/PLAY] button again to stop playback.

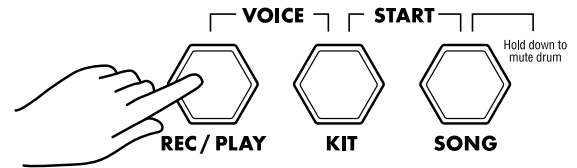

## The [SONG] Button

The SD100KIT contains 10 preset songs and 1 Demo. Press the [SONG] and [KIT] buttons simultaneously to start or stop the song.

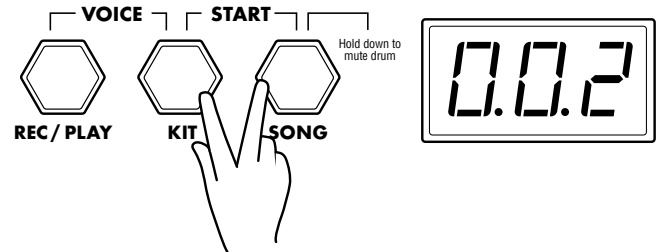

### Drum On/Off

In [SONG] mode, press and hold the [SONG] button for 2 seconds, LED displays "ON" or "OFF".

**On** – turn on the drum track of the song.

**Off** – turn off the drum track of the song.

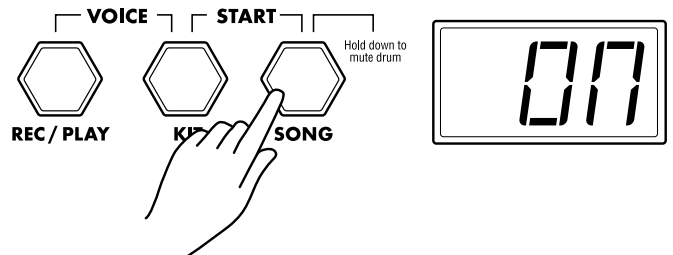

### Select the songs

Press the [SONG] button, then use [+] or [-] buttons to select any of the 10 songs.

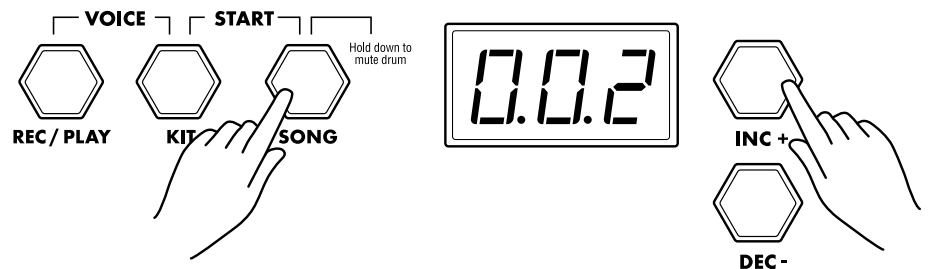

# GETTING STARTED

## Song Volume

In [SONG] mode, press and hold the [SONG] button and use [+] or [-] buttons to adjust the song volume. Range: 000-032.

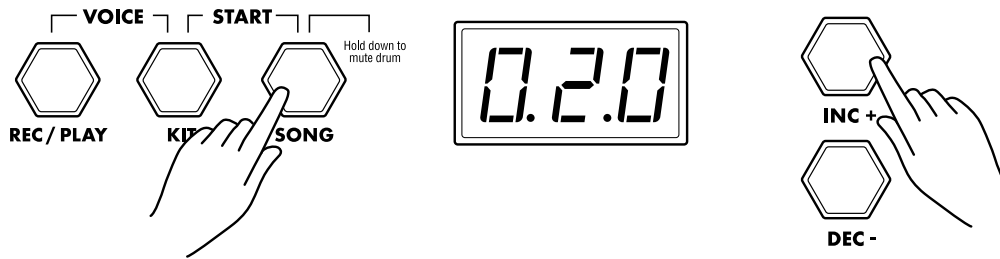

## The [TEMPO/TAP] Button

There are 2 ways you can adjust tempo in the SD100KIT.

Press the [TEMPO/TAP] button. The LED displays the current tempo so use [+] or [-] buttons to adjust tempo value. Range: 020-240

Press the [TEMPO/TAP] button for 2 seconds to enter the TAP mode. The LED display will blink.

Now hit on a pad 4 times rhythmically to change the tempo.



# FACTORY SETTINGS

## To restore your settings to the factory default, do the following:

Turn off the power. Hold down the [INC +] and [DEC -] buttons with one hand, then turn the power on. This will reset your module to factory setup and erase all your settings.



## Setup functions.

Here you can adjust some of the global parameters to suit your playing style.

Turn off the power.

### Set-Up Mode:

Hold down [KIT] button, then turn the power on to enter setup mode.

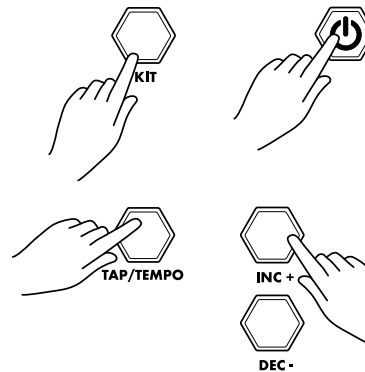

0.0.1

### Sensitivity:

Press [TEMPO/TAP] button, use [+] or [-] buttons to set sensitivity.  
Range: 001-008

### Threshold:

Press [KIT] button, use [+] or [-] buttons to set threshold.  
Range: 000-050

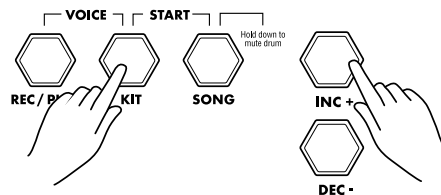

020

### Velocity Curve:

Press [SONG] button, use [+] or [-] buttons to set velocity curve.  
There are four velocity curves from which to choose:  
Normal (NOR), Dynamic (DYN), EASY (ESY), and Fixed (FID).

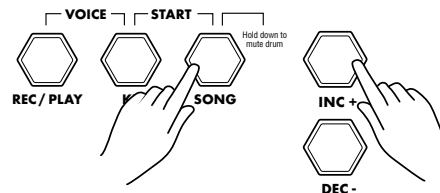

NOR

### Cross Talk:

Press [CLICK] button, use [+] or [-] buttons to set XTALK.  
Range: 000-080

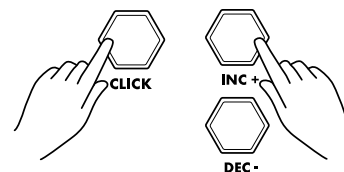

0.2.0

### Saving Set-up Functions:

Press [REC/PLAY] buttons to save above settings.

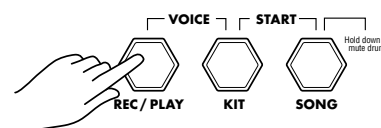

SAV

### Power saving option:

Your SD100KIT will automatically turn off after 30 minutes of non-use. To switch the power saving mode on or off, hold down the (KIT) button, then turn the power on to enter setup mode. While in set up mode, press the (REC/PLAY) button and hold for 2 seconds. (Factory default is set to off).

SON = Power saving ON. SOF = Power saving OFF.

# DRUM KIT PRESETS

## Preset Drum Kit List

---

Kit #	Kit Name
Kit 1	Maple
Kit 2	Funk 1
Kit 3	Studio
Kit 4	Hip Hop
Kit 5	Metal
Kit 6	Simmons
Kit 7	Jazz
Kit 8	Latin Percussion
Kit 9	LA Funk Rock
Kit 10	Techno
Kit 11	User Kit

## Song Style List

---

Style #	Style Name
d-1	Demo Song
01	Bonz Beat
02	Blues Beat
03	Black Magic
04	Alt Rock
05	Funky Strut
06	Hip Hop
07	Funky D
08	Tech Step
09	Metalhead
10	Jazz Walk



# DRUM KIT PRESETS

## Drum Sound List

### KICK

BD\_Maple  
BD\_HeavyMetal  
BD\_Jazz  
BD\_LAFunkRock  
BD\_Metal  
BD\_MetalGuitar-Kick  
BD\_Studio  
BD\_Thickick  
BD\_Vintage  
EDRM\_BD-HipHopcp1  
EDRM\_BD-Techno1Cp  
EDRM\_BD808Kick  
BD\_Banzai\_Kick  
BD\_WahKick  
BD\_PunchKick

### SNARE

SD\_Aluminum\_Center  
SD\_Aluminum\_CS  
SD\_Aluminum\_RS  
SD\_BellBrass\_center  
SD\_BellBrass\_CS  
SD\_BellBrass\_RS  
SD\_Brass\_RS  
SD\_Brass-center  
SD\_Brass-CS  
SD\_BrushSnare-center  
SD\_BrushSnare-Rim  
SD\_DeepBrass-Center  
SD\_DeepBrass-CS  
SD\_DeepBrass-RS  
SD\_Funk1\_CenterA  
SD\_HeavyMetal  
SD\_LAFunkrock\_CenterA  
SD\_LAFunkrock\_CS  
SD\_LAFunkrock\_RS  
SD\_Maple\_CenterA  
SD\_Maple\_RS  
SD\_Metal-CenterA  
SD\_Metal-CS  
SD\_Metal-RS  
SD\_ShallowBrass-Center  
SD\_ShallowBrass-CS  
SD\_ShallowBrass-RS  
SD\_ShallowWood-CenterA  
SD\_ShallowWood-CS

SD\_ShallowWood-RS  
SD\_SteelSnare\_Center  
SD\_SteelSnare\_CS  
SD\_SteelSnare\_RS  
SD\_SteelSnare2-Center  
SD\_SteelSnare2-CS  
SD\_SteelSnare2-RS  
SD\_Studio\_CenterA  
SD\_Studio\_CS  
SD\_Studio\_RS  
SD\_Vintage  
EDRM\_SD-HipHopcp1  
EDRM\_SD-Techno1Cp  
SD\_SynthSnare  
SD\_LoFiSnare  
SD\_HipHopSnare

### TOM

TOM\_Brush-Hi  
TOM\_Brush-Lo  
TOM\_HeavyMetal-Hi  
TOM\_HeavyMetal-Low  
TOM\_HeavyMetal-Mid  
TOM\_LAFunk\_Hi  
TOM\_LAFunk\_Low  
TOM\_LAFunk\_Mid  
TOM\_Maple\_Hi  
TOM\_Maple\_Low  
TOM\_Maple\_Mid  
TOM\_Metal-Hi  
TOM\_Metal-Low  
TOM\_Metal-Mid  
TOM\_Studio\_Hi  
TOM\_Studio\_Low  
TOM\_Studio\_Mid  
TOM\_Vintage-Hi  
TOM\_Vintage-Low  
TOM\_Vintage-Mid  
EDRM\_Simmons\_Tom1Cp-Hi  
EDRM\_Simmons\_Tom1Cp-Low  
EDRM\_Simmons\_Tom1Cp-Mid  
EDRM\_Simmons\_Tom1Cp  
EDRM\_Tom-Techno1-Hi  
EDRM\_Tom-Techno1-Low  
EDRM\_Tom-Techno1-Mid  
EDRM\_Simmons\_Kick1Cp  
EDRM\_Simmons\_Snare1Cp

### CYMBALS

CYM\_China  
CYM\_Crash1  
CYM\_Crash2  
CYM\_Ride-MetalPingA  
CYM\_Ride1-Bella  
CYM\_Ride1-BowA-0  
CYM\_Ride1-BowA  
CYM\_Ride2-Bella  
CYM\_Ride2-Bow  
CYM\_Ride2-CrashEdge  
ECYM\_808Cymbal  
ECYM\_Ride-Simmons1  
ECYM\_Simmons\_Crash1cp  
ECYM\_Techno\_CrashChinaElec  
ECYM\_SimmonsRide

### HI HAT

CYM\_HH1-Closed-0  
CYM\_HH1-Closed-1  
CYM\_HH1-Foot-0  
CYM\_HH1-Foot-1  
CYM\_HH1-Open-0  
CYM\_HH1-Open-1  
CYM\_HH2-Closed  
CYM\_HH2-Foot  
CYM\_HH2-Open  
CYM\_HH3-Closed  
CYM\_HH3-Foot  
CYM\_HH3-Open  
ECYM\_HH-Foot  
ECYM\_HHClosed4  
ECYM\_HipHopHHClsd1  
ECYM\_HipHopHHOpen1  
ECYM\_SimmonsHHOpen03  
ECYM\_Techno\_ClsdHH2cp  
ECYM\_Techno\_OpenHH1Cp

### PERCUSSION

PERC\_Agogo-Large  
PERC\_Agogo-Small  
PERC\_Bongo-Large  
PERC\_Bongo-Small  
PERC\_Cabasa  
PERC\_Clave  
PERC\_Conga-Slap  
PERC\_Conga

PERC\_Cowbell\_Open  
PERC\_Cowbell-  
Mute2Open  
PERC\_Guaro  
PERC\_Marcas  
PERC\_Quica-Down  
PERC\_Quica-Hi\_tone  
PERC\_Shaker  
PERC\_Sleighbells  
PERC\_Small  
PERC\_Surdo  
PERC\_Tambourine-Slap  
PERC\_Timbale-Hi  
PERC\_Timbale  
PERC\_Triangle-Mute  
PERC\_Triangle-  
Mute2Open  
PERC\_Triangle-Open  
PERC\_Tumba-Open-Slap  
PERC\_Tumba-Slap  
PERC\_Tumba  
PERC\_Vibraslap  
PERC\_Whistle-Long  
PERC\_Whistle  
PERC\_Woodblock-Lo  
PERC\_Woodblock  
EPERC\_808claps  
EPERC\_808Conga  
EPERC\_808Cowbell  
EPERC\_BigClap  
EPERC\_Bleep  
EPERC\_FilterSnap  
EPERC\_Kling  
EPERC\_Ping  
EPERC\_Punch  
EPERC\_PsychoRainstick  
PERC\_BigDrum  
PERC\_CongaTumba  
BD\_ElectroKick  
EPERC\_DigitalChimes  
EPERC\_Bass-SlapPhrase3

### KEYBOARD SOUNDS

AC Bass  
Synth Bass 1  
Synth Bass 2  
Synth Bass 4

Synth Bass 3  
Synth Bass 5  
Slap Bass  
Strut Guitar  
Distorted Guitar  
Wah Wah  
Muted Stock  
Distorted Stock  
Crunch Guitar  
Acoustic Piano  
Ep1  
Horn Section  
Organ 1  
Organ 2  
Synth 1

### KITS

Maple  
Funk 1  
Studio  
Hip Hop  
Metal  
Simmons  
Jazz  
Latin Percussion  
LA Funk Rock  
Techno  
User Kit

## MIDI IMPLEMENTATION CHART

O: YES X: NO

Function		Transmitted	Recognized	Remarks
Basic Channel	Default	10CH	1-16	Memorized
	Changed	X	1-16 each	
Mode	Default	Mode 3	Mode 3	
	Messages	X	X	
	Altered	*****	X	
Note Number	True Voice	0-127	0-127	
		*****	0-127	
Velocity	Note ON	O (99H, V=1-127)	O (9nH, V=1-127)	
	Note OFF	O (89H, V=0)	O (8nH, V=0) or 8nH	
Aftertouch		X	X	
Pitch Blend		X	O	
Control Change	0, 32	X	O	Bank Select
	1	X	O	Modulation
	5	X	O	Portamento Time
	6	X	O	Data Entry
	7	X	O	Volume
	10	X	O	Pan
	11	X	O	Expression
	64	X	O	Sustain
	65	X	O	Portamento
	66	X	O	Sostenuto
	67	X	O	Soft Pedal
	80, 81	X	O	DSP TYPE
	91, 93	X	O	DSP DEPTH
	100, 101	X	O (*1)	RPN LSB, MSB
	121	X	O	Reset all Controllers
Program Change		O 0-10	O 0-127	
	True member		0-127	
System Exclusive		X	X	
System Common	:Song Position	X	X	
	:Song Select	X	X	
	:Tune	X	X	
System Real Time	:Clock	X	X	
	:Commands	X	X	
Aux Messages	:Local ON/OFF	X	X	All Notes OFF is sent as All Sound OFF (CC# 120)
	:All Notes OFF	X	O	
	:Active Sense	X	X	
	:Reset	X	O	

\*1: Registered parameter number: #0: Pitch sensitivity, #1: Fine tuning, #2: Coarse tuning

Model 1: OMNI ON, POLY  
 Mode 2: OMNI ON, MONO  
 Mode 3: OMNI OFF, POLY  
 Mode 4: OMNI OFF, MONO

# SPECIFICATIONS

<b>Pads</b>	7 drum pads with touch response and includes two pedals for bass drum and hi-hat
<b>Sounds</b>	170 percussion voices
<b>Drum Sets</b>	10 preset sets, 1 User set
<b>Songs</b>	10 songs and one demo
<b>Overall Controls</b>	Tempo, Main Volume
<b>Metronome</b>	Voice, Click or Light
<b>Connections</b>	9V adapter, head phones, USB to host (MIDI IN/OUT), bass drum and hi-hat controller
<b>Dimensions</b>	709.93mm (W) x 230.12mm (D) x 812.29mm (H) 27.95" (W) x 9.06" (D) x 31.98" (H)
<b>Weight</b>	8.2kgs
<b>Power Supply</b>	9V adapter
<b>Accessories</b>	Drum sticks, two controller pedals

# WARRANTY

## Two (2) Year Limited Warranty

Subject to the limitations set forth below, Simmons® hereby represents and warrants that the components of this product shall be free from defects in workmanship and materials, including implied warranties of merchantability or fitness for a particular purpose, subject to normal use and service, for two (2) years to the original owner from the date of purchase.

Retailer and manufacturer shall not be liable for damages based upon inconvenience, loss of use of product, loss of time, interrupted operation or commercial loss or any other incidental or consequential damages including but not limited to lost profits, downtime, goodwill, damage to or replacement of equipment and property, and any costs of recovering, reprogramming, or reproducing any program or data stored in equipment that is used with Simmons® products. This guarantee gives you specific legal rights. You may have other legal rights which vary from state to state. Some states do not allow limitations on how long an implied warranty lasts, so the above limitation may not apply to you.

Simmons  
P.O. Box 5111  
Thousand Oaks, CA 91359-5111

All trademarks and registered trademarks mentioned herein are recognized as the property of their respective holders.  
Made in China

## FCC Statements

1. Caution: Changes or modifications to this unit not expressly approved by the party responsible for compliance could void the user's authority to operate the equipment.
2. Note: This equipment has been tested and found to comply with the limits for a Class B digital device, pursuant to Part 15 of the FCC Rules. These limits are designed to provide reasonable protection against harmful interference in a residential installation. This equipment generates, uses, and can radiate radio frequency energy and, if not installed and used in accordance with the instructions, may cause harmful interference to radio communications. However, there is no guarantee that interference will not occur in a particular installation. If this equipment does cause harmful interference to radio or television reception, which can be determined by turning the equipment off and on, the user is encouraged to try to correct the interference by one or more of the following measures:

- Reorient or relocate the receiving antenna.
- Increase the separation between the equipment and receiver.
- Connect the equipment into an outlet on a different circuit.
- Consult an experienced radio/TV technician for help.

